

## REMOVAL

**⚠ CAUTIONS:**

- Use a suitable trim tool.
- Make sure to protect the paintwork.

**⚠ NOTES:**

- This procedure contains some variation in the illustrations depending on the vehicle specification, but the essential information is always correct.
- This procedure contains illustrations showing certain components removed to provide extra clarity.
- This procedure contains illustrations for left side components, right side components are similar.

1. Disconnect the startup battery ground cable.

Refer to: [Startup Battery Disconnect and Connect](#) (414-00 Battery and Charging System - General Information, General Procedures).

- 2.

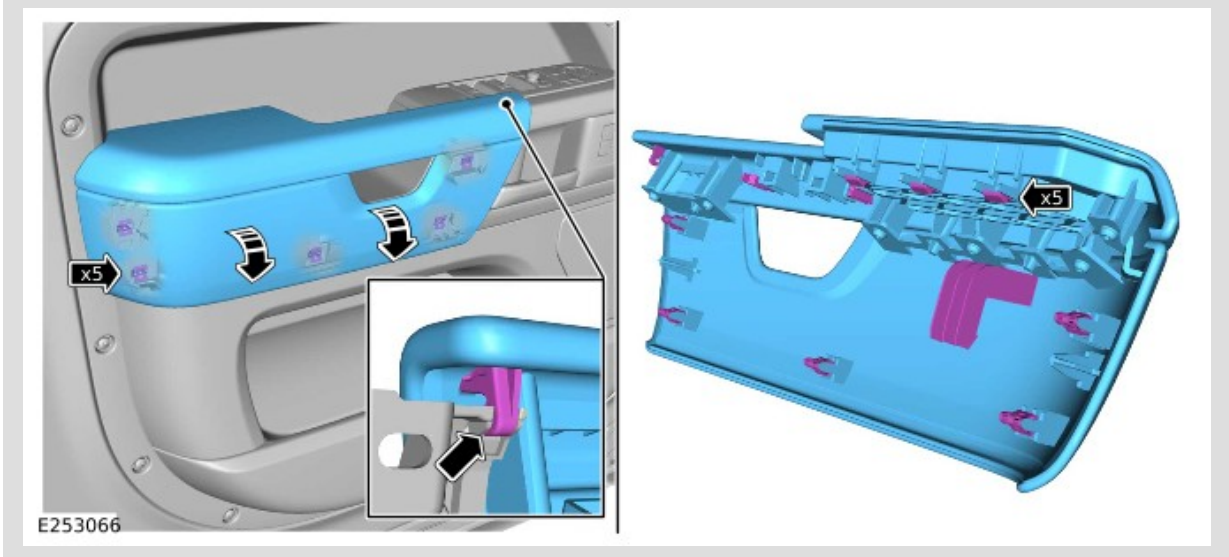

- Release the 11 clips.
- Remove the front door armrest trim.

3.

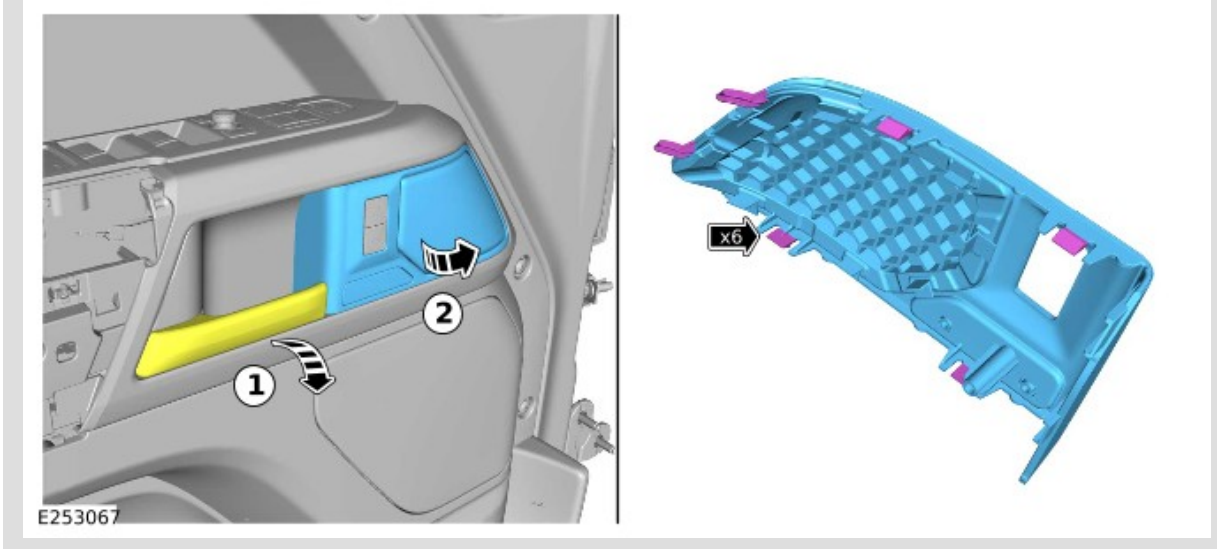

1. Open the front door interior handle.
2. Remove the mid-range speaker trim.

4.

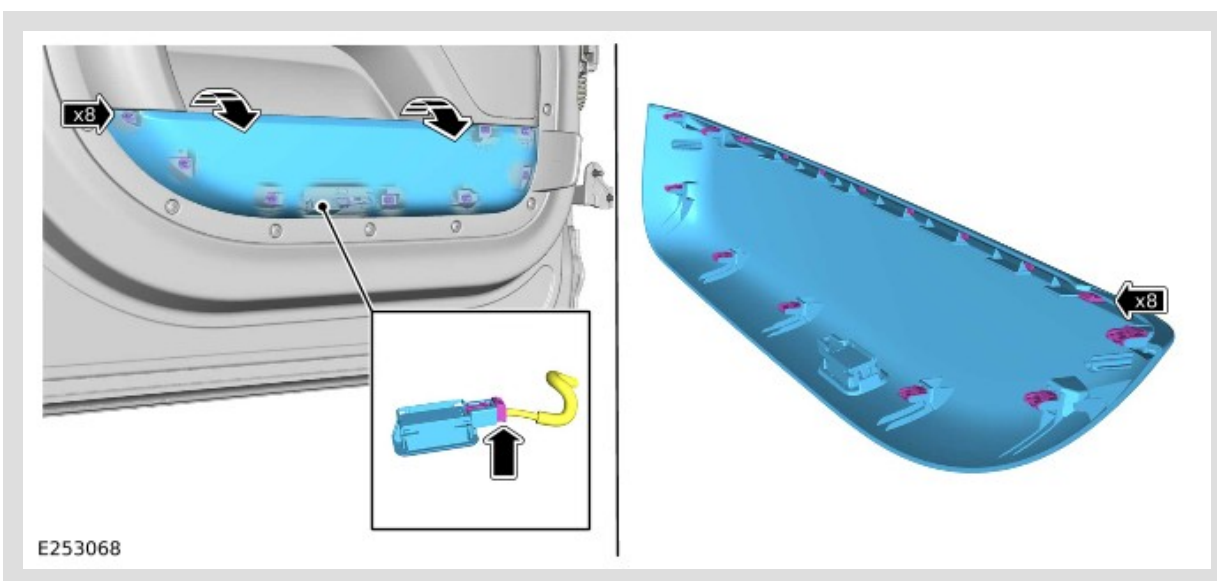

- Release the 16 clips.
- Disconnect the electrical connector from the front door ambience lighting.
- Remove the front door pocket trim.

5.

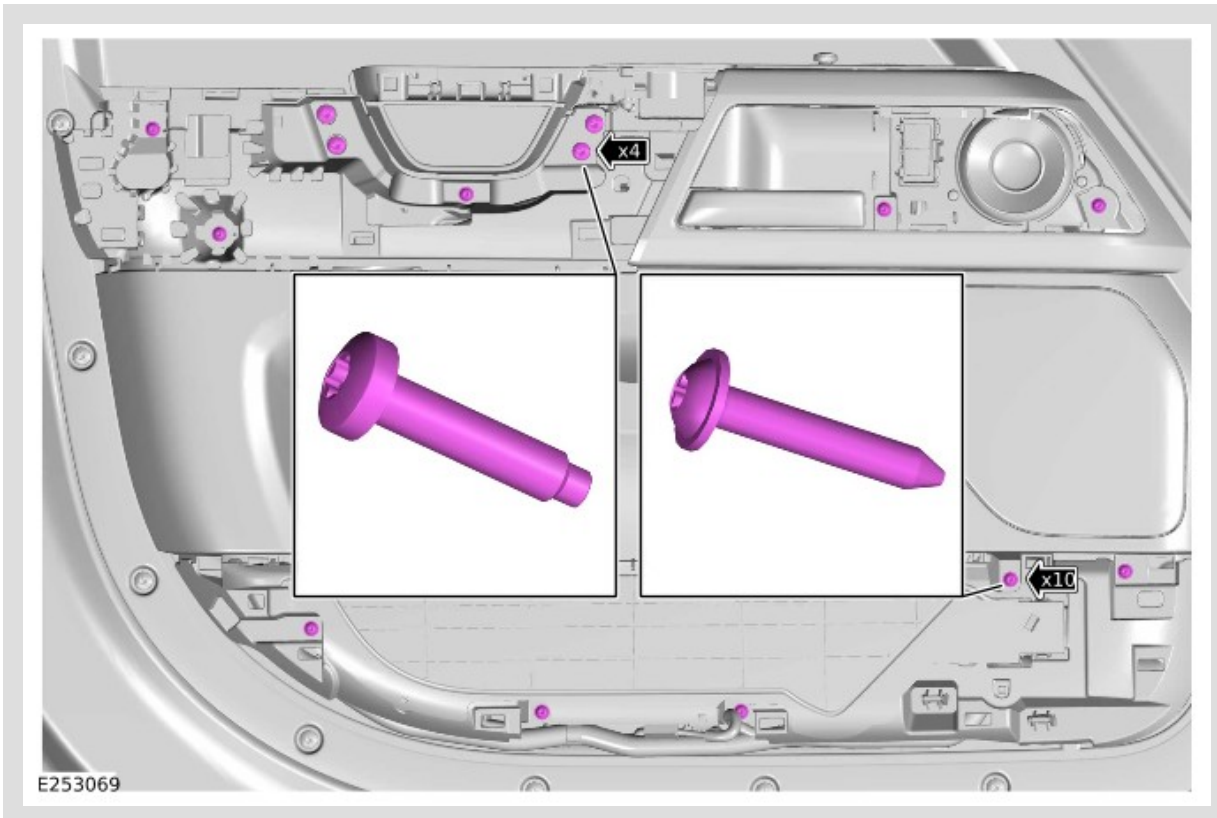

- Remove the 4 bolts.
- Remove the 10 screws.

6.

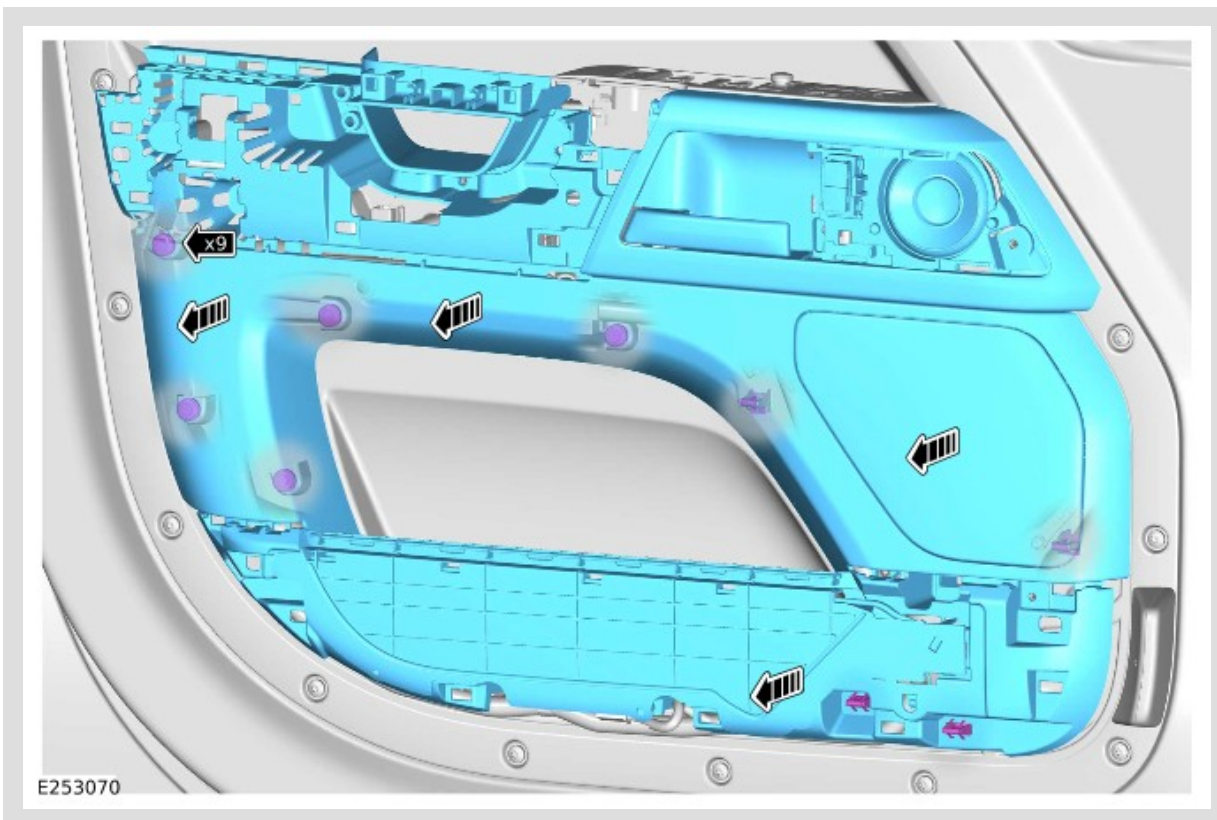

- Release the 9 clips.
- Remove the front door trim panel.

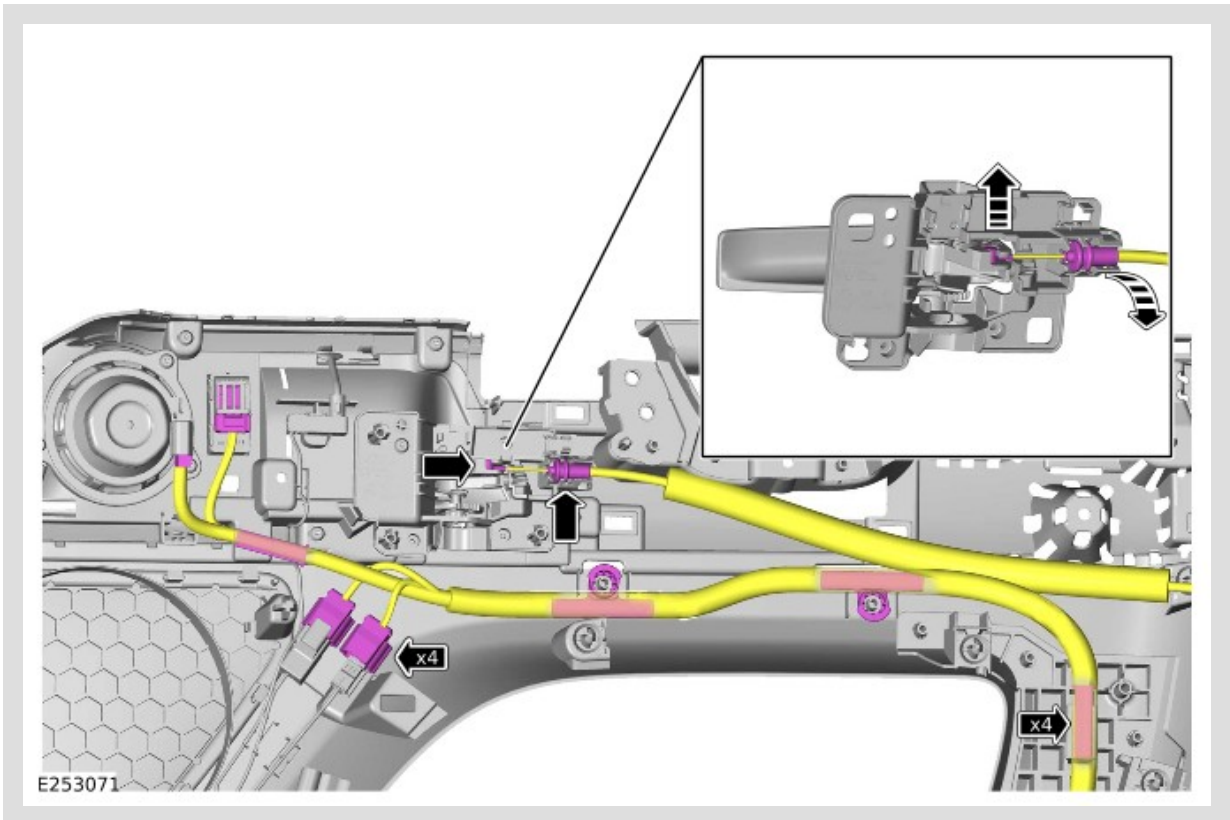

- Release and disconnect the front door interior handle cable.
- Disconnect the electrical connector from the mid-range speaker.
- Disconnect the electrical connector from the central door locking switch.
- Disconnect the 2 electrical connectors from the front door ambience lighting wiring harness.
- Release the 4 wiring harness clips.