



COMPRESSOR

Service repair no - 82.10.20

Remove

1. Disconnect battery negative lead.
2. Recover refrigerant from air conditioning system.
See Adjustment, Refrigerant Recovery Recycling Recharging
3. Remove screws retaining centre panel to fan cowl
4. Remove centre panel.

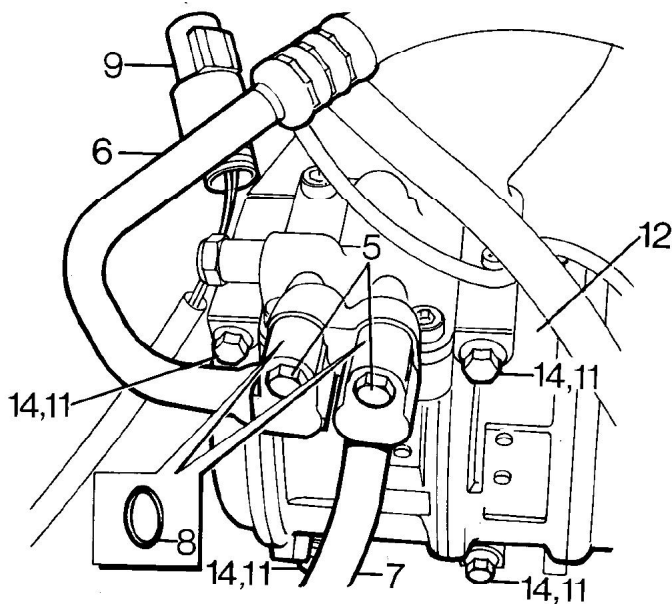

RR3967M

6. Disconnect high pressure hose from compressor.
7. Disconnect low pressure hose from compressor.
8. Remove 'O' ring from each flange.
9. Disconnect electrical lead from compressor clutch.
10. Release drive belt from compressor pulley. **See ENGINE, Repair, Drive Belt**
11. Remove 4 bolts securing compressor to mounting bracket.
12. Remove compressor from mounting bracket.

Refit

13. New compressor to be fitted: Drain oil from new compressor outlet port. Drain and measure oil from old compressor. Measure new oil equal to amount drained from old compressor, add 30 ml extra to this amount and refill new compressor through outlet port.
14. Locate compressor in mounting bracket, fit bolts. Tighten to **25 Nm**.
15. Connect electrical lead to compressor clutch.
16. Fit new 'O' rings to high and low pressure hose flanges, lubricate with refrigerant oil.
17. Engage hose flanges, fit bolts. Tighten to **10 Nm**.
18. Fit compressor drive belt. **See ENGINE, Repair, Drive Belt**
19. Fit centre panel to fan cowl.
20. Evacuate and recharge air conditioning system.
See Adjustment, Refrigerant Recovery Recycling Recharging
21. Perform a leak test on disturbed joints.
22. Carry out a functional check.

V8i engine illustrated

5. Remove 2 bolts securing hose flanges to compressor.



WARNING: Wear eye and hand protection when disconnecting components containing refrigerant. Plug all exposed connections immediately.