



Lamp - front repeater - up to 03MY

🔑 86.40.42

Remove

1. **For RH repeater lamp:** Release fixings and remove battery cover.

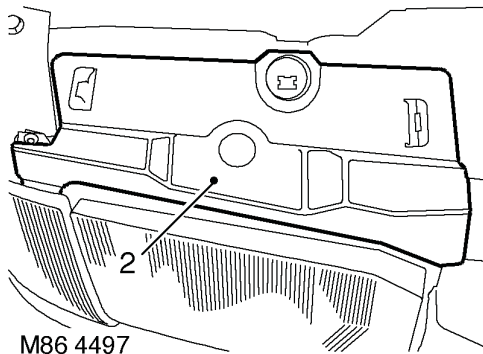

2. Remove headlamp access cover from body.

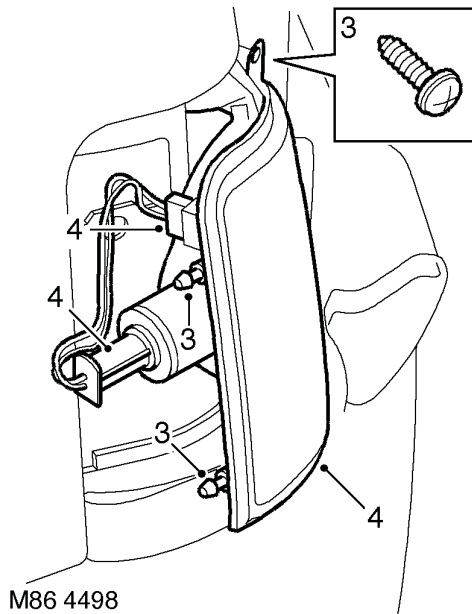

3. Remove screw securing repeater lamp to body and release lamp from 2 locating peg sockets in wing.
4. Disconnect 2 multiplugs from repeater lamp and remove lamp.

Refit

1. Position new repeater lamp and connect multiplugs.
2. Fit repeater lamp to body and tighten screw.
3. Fit headlamp access cover.
4. **For RH repeater lamp:** Fit battery cover and secure fixings.

LIGHTING

Headlamp - up to 03MY

🔑 86.40.49

Remove

1. **For RH headlamp:** Release fixings and remove battery cover.

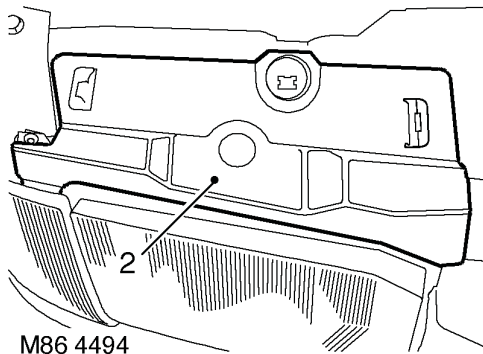

M86 4494

2. Remove headlamp access cover from body.

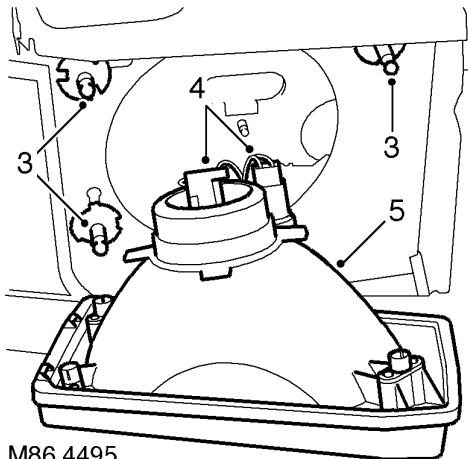

M86 4495

3. Release headlamp from locating sockets.
4. Disconnect multiplugs from headlamp and side lamp bulbs.
5. Remove headlamp.

NOTE: Do not carry out further dismantling if component is removed for access only.

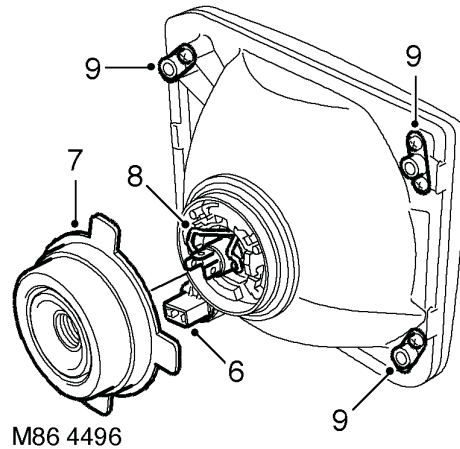

M86 4496

6. Remove side lamp bulb holder from headlamp.
7. Remove rubber cover from headlamp.
8. Release headlamp bulb retaining clip and remove headlamp bulb.
9. Remove 6 screws and remove headlamp retaining sockets.

Refit

1. Fit retaining sockets to new headlamp and secure with screws.
2. Fit headlamp bulb and secure with clip.
3. Fit rubber cover.
4. Fit side lamp bulb holder.
5. Position headlamp and connect multiplugs.
6. Fit headlamp onto locating pins.
7. Check headlamp beam alignment.

LIGHTING, ADJUSTMENTS, Headlamps beam alignment - up to 03MY.

8. Fit headlamp access cover.
9. **For RH headlamp:** Fit battery cover and secure with fixings.



Headlamp - from 03MY

🔑 86.40.49

Remove

1. Remove front grille.
 **EXTERIOR FITTINGS, REPAIRS, Grille - front - from 03MY.**
2. Protect bumper.

CAUTION: Always protect paintwork when removing or refitting any body trims or bumpers.

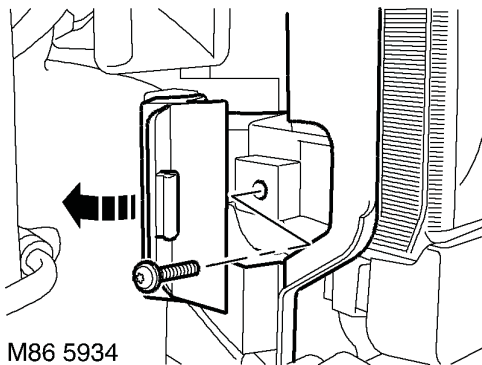

M86 5934

3. Open air deflector access panel and remove Torx screw securing headlamp assembly to the front panel.

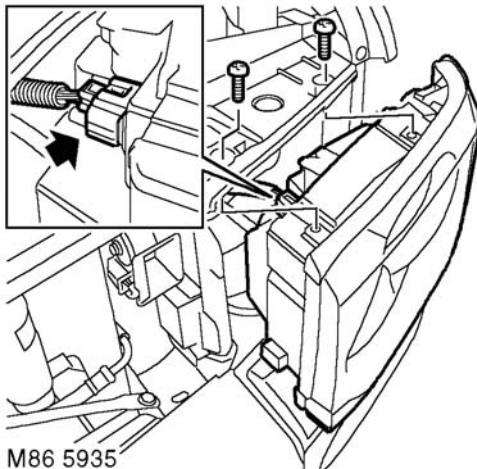

M86 5935

4. Remove 2 screws securing headlamp assembly to the bonnet locking platform.

5. Release headlamp assembly from wing, disconnect multiplug and remove the headlamp assembly.

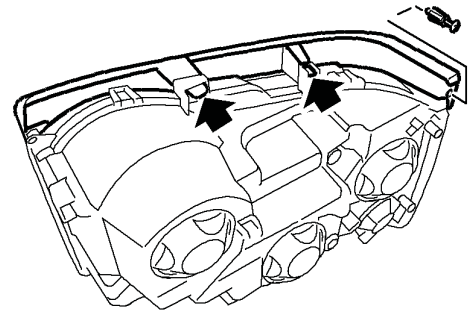

NOTE: Do not carry out further dismantling if component is removed for access only.



M86 5936

6. Remove scrivet securing headlamp finisher to headlamp assembly, release and remove the finisher.

Refit

1. Fit and secure headlamp finisher to the headlamp assembly.
2. Position headlamp assembly to front panel and connect the multiplug.
3. Secure headlamp assembly to the front wing.
4. Fit and tighten screws securing headlamp assembly to the bonnet locking platform.
5. Fit and tighten Torx screw securing headlamp assembly to the front panel. Close the air deflector access panel.
6. Remove bumper protection.
7. Fit front grille.
 **EXTERIOR FITTINGS, REPAIRS, Grille - front - from 03MY.**
8. Check headlamp alignment - adjust if necessary.
 **LIGHTING, ADJUSTMENTS, Headlamps beam alignment - from 03MY.**

LIGHTING

Lamp - tail

🔑 86.40.70

Remove

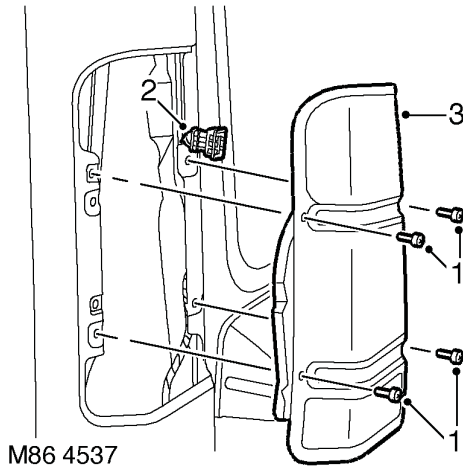

M86 4537

1. Remove 4 screws securing tail lamp to body.
2. Disconnect multiplug from tail lamp.
3. Remove tail lamp.

Refit

1. Position tail lamp to body and connect multiplug.
2. Secure tail lamp to body with screws.

Lamp - front fog up to 03MY

🔑 86.40.95

Remove

1. Raise front of vehicle, one side.

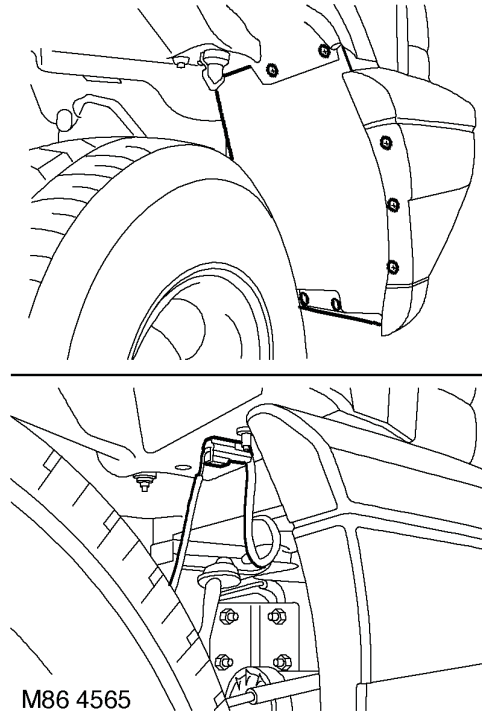

M86 4565

2. **For RH lamp:** Remove 7 screws securing wheel arch liner extension to liner and bumper valance and remove liner extension. Disconnect lamp multiplug from harness.
3. **For LH lamp:** Remove front bumper assembly.
👉 **EXTERIOR FITTINGS, REPAIRS, Bumper assembly - front.**

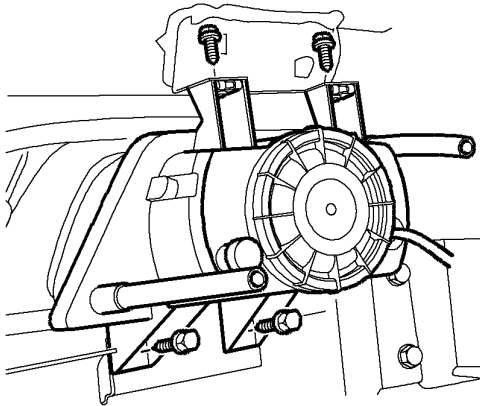

M86 4566

4. Remove 4 screws and remove lamp.

Refit

1. Fit new lamp and secure with screws.
2. **For LH lamp:** Fit front bumper assembly.
 **EXTERIOR FITTINGS, REPAIRS, Bumper assembly - front.**
3. **For RH lamp:** Connect multiplug to harness. Fit wheel arch liner extension, secure to bumper valance and liner with screws.
4. Lower vehicle.

Lamp - front fog from 03MY

 86.40.96

Remove

1. Remove the front bumper finisher.
 **EXTERIOR FITTINGS, REPAIRS, Trim finisher - bumper - front - from 03MY.**

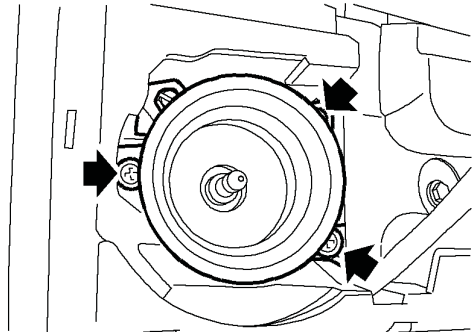

M86 5937

2. Remove 3 screws securing the fog lamp to the bumper.

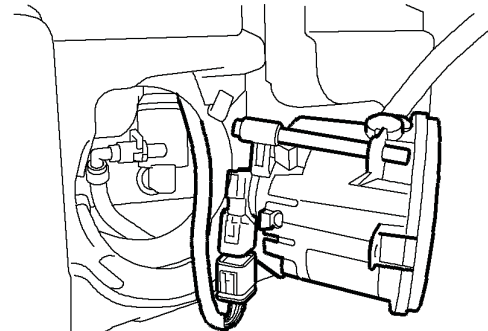

M86 5938

3. Disconnect the fog lamp multiplug and remove the fog lamp.

Refit

1. Position the fog lamp to the bumper, connect the multiplug and secure with screws.
2. Fit the front bumper finisher.
 **EXTERIOR FITTINGS, REPAIRS, Trim finisher - bumper - front - from 03MY.**

Housing - number plate lamp

🔑 86.40.98

Remove

1. Remove tail door latch and motor.
 **DOORS, REPAIRS, Latch and motor**
 - tail door.

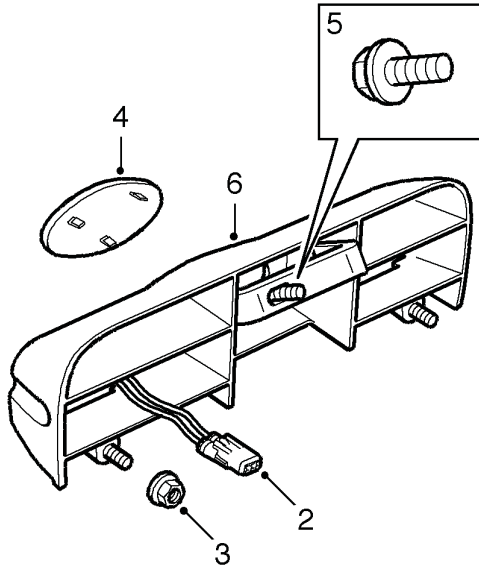

M86 4455

2. Disconnect lamps multiplug.
3. Remove 2 nuts securing housing to door.
4. Carefully release and remove Land Rover badge from housing.
5. Remove bolt securing housing to door.
6. Remove housing from door.

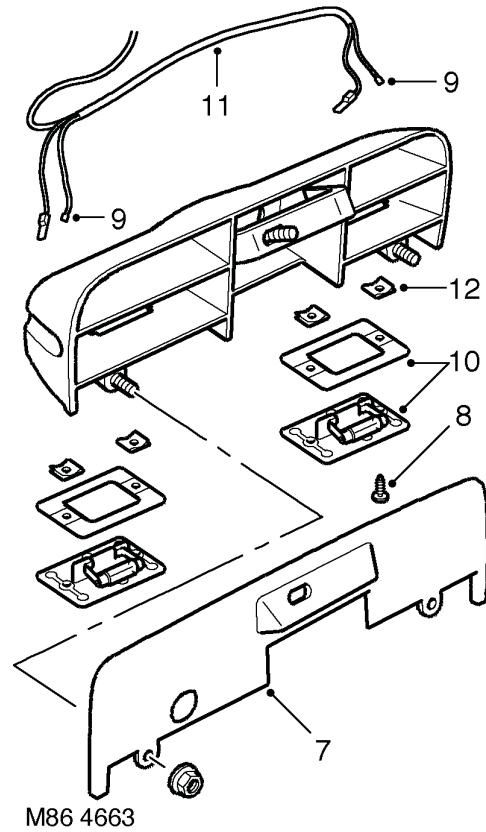

M86 4663

7. Remove housing seal.
8. Remove 4 screws securing lamps to housing.
9. Disconnect 4 Lucar connectors from lamps.
10. Remove lamps and lamp seals.
11. Remove lamp harness from housing.
12. Remove 4 speed nuts from housing.

Refit

1. Fit 4 speed nuts to housing.
2. Fit lamp harness to housing.
3. Fit lamps and lamp seals.
4. Connect 4 Lucar connectors to lamps.
5. Fit 4 screws securing lamps to housing.
6. Position seal to housing.
7. Position housing and seal to tail door and secure with bolt tightened to 3 Nm (2.2 lbf.ft).
8. Fit Land Rover badge to number plate lamp housing.
9. Fit nuts to number plate housing and tighten to 3 Nm (2.2 lbf.ft).
10. Connect lamps multiplug.
11. Fit tail door latch and motor.
 **DOORS, REPAIRS, Latch and motor**
 - tail door.



Motor - headlamp levelling

86.41.16

Remove

1. For RH headlamp levelling motor: Release fixings and remove battery cover.

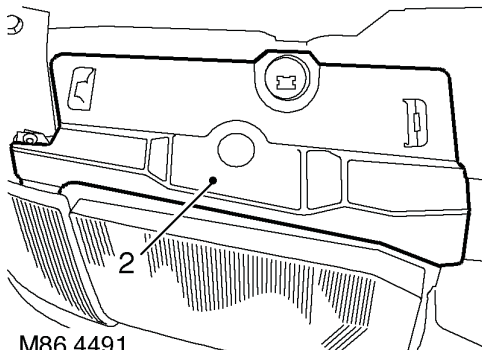

2. Remove headlamp access cover.

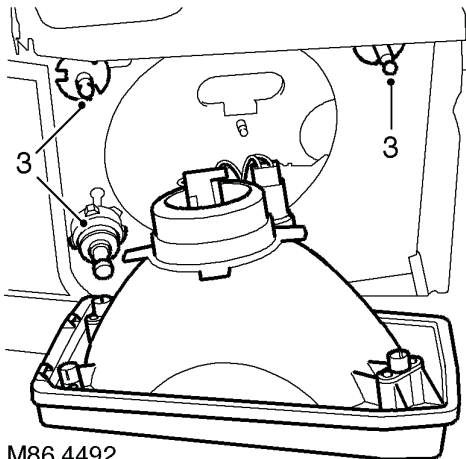

3. Release headlamp from adjuster pin sockets.

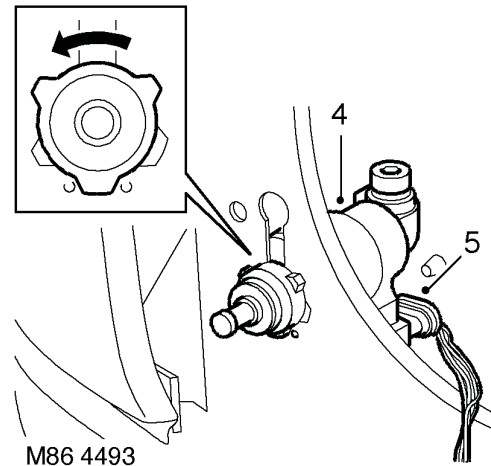

4. Rotate and remove motor from body panel.
5. Disconnect multiplug from motor.
6. Remove headlamp levelling motor.

Refit

1. Position new headlamp levelling motor and connect multiplug.
2. Fit motor to body panel.
3. Fit headlamp to adjuster pins.
4. Check headlamp beam alignment.
LIGHTING, ADJUSTMENTS,
Headlamps beam alignment - up to 03MY.
5. Fit headlamp access cover.
6. For RH headlamp levelling motor: Fit and secure battery cover with fixings.

LIGHTING

Lamp - stop - centre high mounted (CHMSL)

🔑 86.41.32

Remove

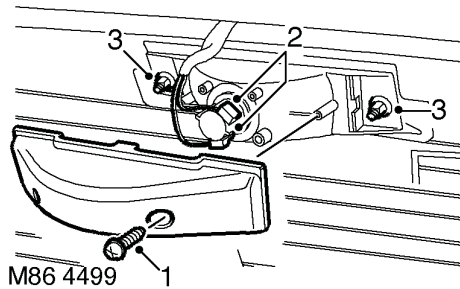

1. Remove 2 screws securing lamp cover and remove cover.
2. Disconnect Lucar connectors from lamp bulb holder.
3. Remove 2 nuts securing lamp to rear screen and remove lamp.

Refit

1. Fit new lamp to screen and secure with nuts.
2. Connect Lucar connectors to lamp bulb holder.
3. Fit lamp cover to lamp and secure with screws.

Lamp - tail/flasher - bumper

🔑 86.41.42

Remove

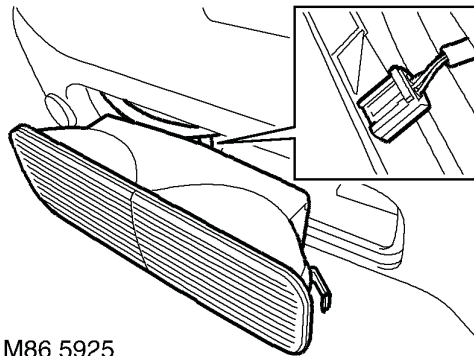

1. Release tail lamp from bumper.
2. Disconnect multiplug and remove lamp.

Refit

1. Position tail lamp, connect multiplug and secure lamp to bumper.



Lamp - interior - front

🔑 86.45.09

Introduction

This procedure is also applicable for removal and fitting of the loadspace lamp.

Remove

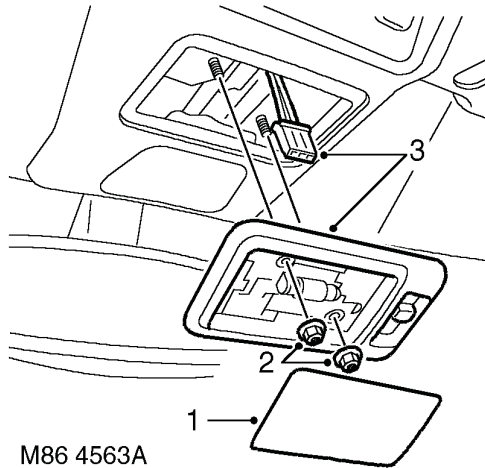

1. Remove interior lamp lens.
2. Remove two nuts securing lamp.
3. Release lamp and disconnect multiplug.
4. Remove lamp.

Refit

1. Position new lamp and connect multiplug.
2. Fit lamp and secure with nuts.
3. Fit interior lamp lens.

Lamp - interior - rear

🔑 86.45.18

Remove

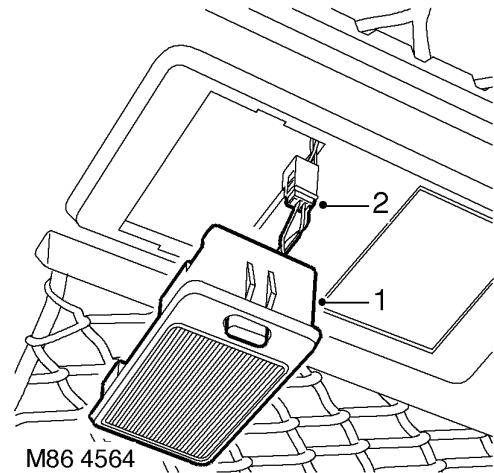

1. Release lamp from headlining.
2. Disconnect multiplug and remove lamp.

Refit

1. Position interior lamp and connect multiplug.
2. Fit lamp to headlining.

LIGHTING

Rheostat - panel lights dimmer

🔑 86.65.37

Remove

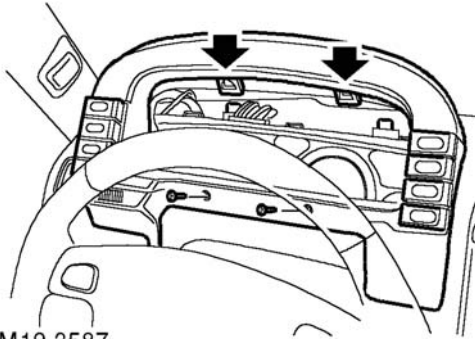

M19 3587

1. Remove 2 screws securing instrument cowl to fascia and release the cowl from the retaining clips.

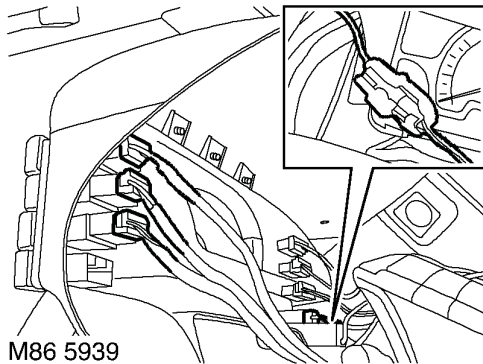

M86 5939

2. Disconnect 8 multiplugs from the instrument cowl switches.
3. Remove the instrument cowl.

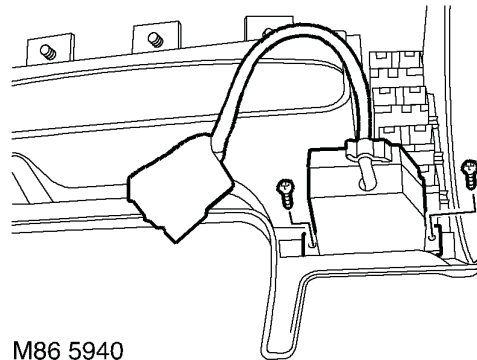

M86 5940

4. Remove 2 screws securing the dimmer switch to the instrument cowl and remove the dimmer switch.

Refit

1. Fit the dimmer switch to the instrument cowl and secure with screws.
2. Position the instrument cowl to the fascia and connect the multiplugs.
3. Fit the instrument cowl to the fascia and secure with screws.



Switch - hazard warning

🔑 86.65.50

Remove

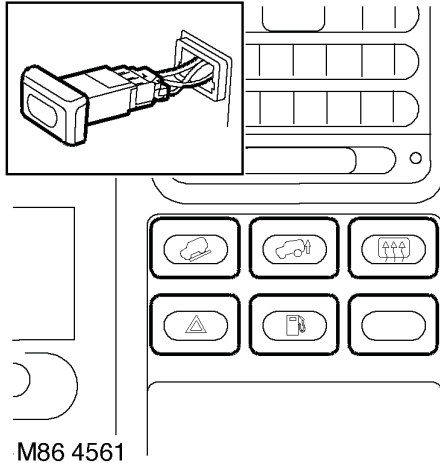

1. Carefully remove switch.
2. Disconnect multiplug from switch.
3. Remove switch.

Refit

1. Connect multiplug switch.
2. Position switch and push to secure.

Switch - indicator and exterior lighting - combined

🔑 86.65.55

WARNING: Always remove the key from the starter switch, disconnect the vehicle battery and wait 10 minutes before commencing work on the SRS system.

Remove

1. Remove rotary coupler.
 - 👉 **RESTRAINT SYSTEMS, REPAIRS, Rotary coupler.**

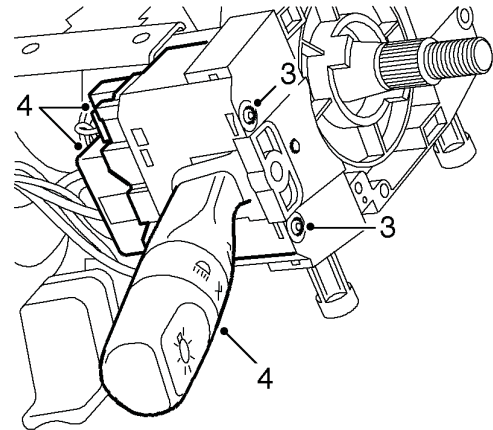

M86 4490

2. Remove 2 screws securing switch.
3. Carefully raise edge of switch bracket to clear location peg and release switch from bracket.
4. Disconnect 2 multiplugs and remove switch.

Refit

1. Position switch and connect multiplugs.
2. Fit switch to bracket and secure with screws.
3. Fit rotary coupler.
 - 👉 **RESTRAINT SYSTEMS, REPAIRS, Rotary coupler.**