



The ECM connector and pins pertinent for secondary air injection are listed in the following table:

Connector / Pin No.	Description	Signal type	Control
C0635-23	Main relay output	Output drive	Switch to ground
C0636-4	Secondary air injection vacuum solenoid valve control	Output, drive	Switch to ground
C0636-16	Secondary air injection pump relay control	Output drive	Switch to ground
C0636-21	Coolant temperature (ECT) sensor	Ground	0V
C0636-22	Coolant temperature (ECT) sensor	Input signal	Analogue 0 - 5V
C0637-20	MIL "ON"	Output drive	Switch to ground

### Secondary Air Injection System Components

The secondary air injection (SAI) system components (where fitted) are described below:

#### Secondary Air Injection (SAI) Pump

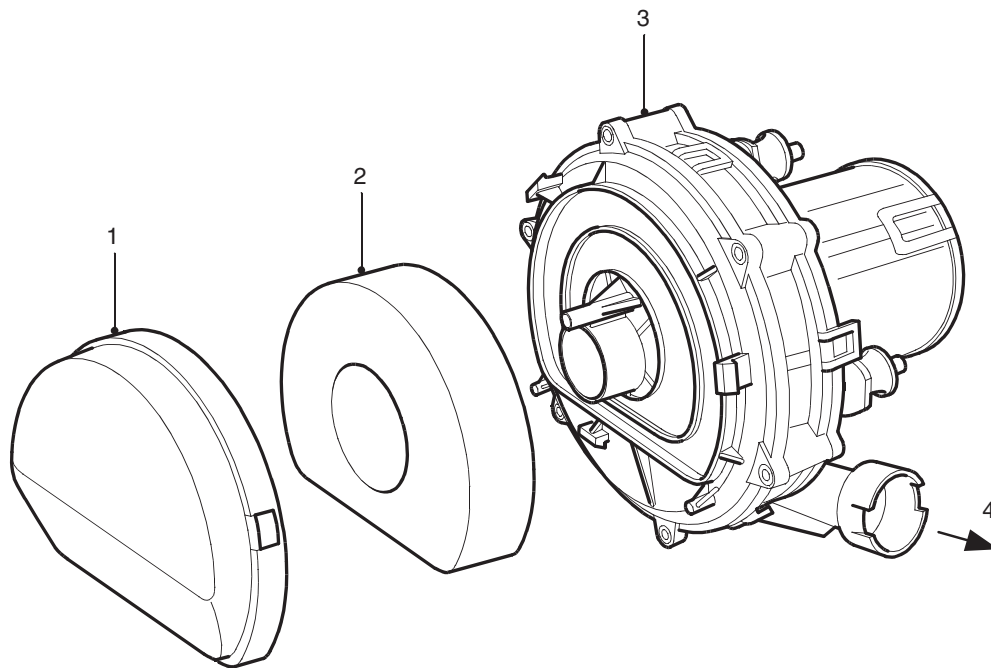

M17 0204

- 1 SAI pump cover
- 2 Foam filter

- 3 SAI pump
- 4 Pressurised air to exhaust manifolds

The SAI pump is attached to a bracket at the rear RH side of the engine compartment and is fixed to the bracket by three studs and nuts. The pump is electrically powered from a 12V battery supply via a dedicated relay and supplies approximately 35kg/hr of air when the vehicle is at idle in Neutral/Park on a start from 20°C (68°F).

Air is drawn into the pump through vents in its front cover and is then passed through a foam filter to remove particulates before air injection. The air is delivered to the exhaust manifold on each side of the engine through a combination of plastic and metal pipes.