

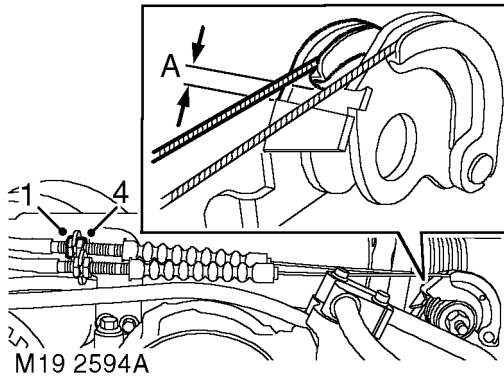

Cable - throttle

➤ 19.20.05

Adjust



1. Loosen outer cable locknuts.
2. Adjust the rear locknut until it is in contact with the back of the abutment bracket, and the gap between the throttle and the inner driven lever is $0.5 \text{ mm} \pm 0.4 \text{ mm}$ ($0.020 \pm 0.015 \text{ in}$).
3. Tighten cable front nut to lock cable to abutment bracket.

Cable - cruise control

➤ 19.75.11

Adjust

1. Ensure that the throttle cable is correctly adjusted.

➤ **ENGINE MANAGEMENT SYSTEM - V8, ADJUSTMENTS, Cable - throttle.**

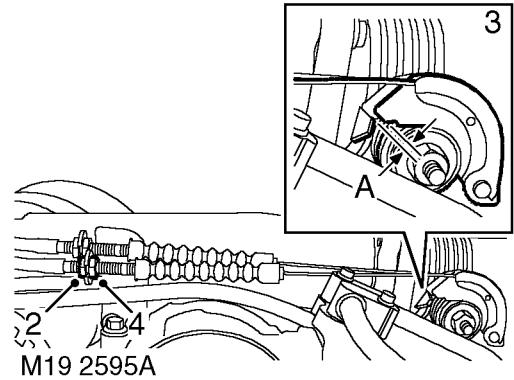

2. Loosen outer cable locknuts.
3. Adjust the rear locknut to obtain a 4.0 to 4.5 mm ($0.157 \text{ to } 0.177 \text{ in}$) gap, **dimension 'A'**, between the cruise control cable lever and the throttle cable driven lever.
4. Tighten cable front locknut.