



## PROPELLER SHAFTS

### Propeller shaft - front

#### 47.15.02

##### Remove

1. Raise front of vehicle.  
**WARNING: Do not work on or under a vehicle supported only by a jack. Always support the vehicle on safety stands.**

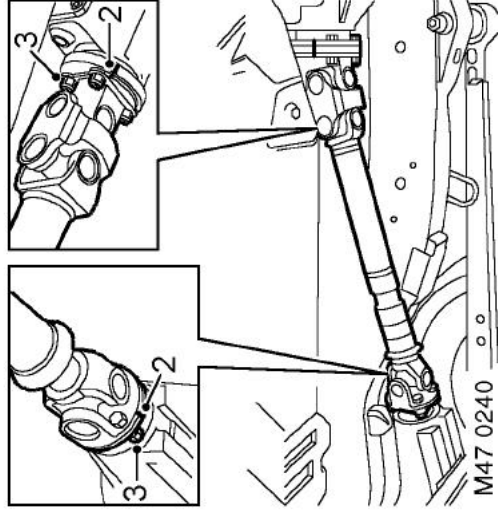

2. If same components to be refitted, reference mark propeller shaft and mating components.
3. Remove 8 nuts and bolts securing propeller shaft to differential and transfer gearbox flanges.
4. Remove propeller shaft.

##### Refit

1. Clean propeller shaft flanges and mating faces.
2. Position propeller shaft to transfer gearbox and differential and tighten nuts and bolts to 47 Nm (35 lbf. ft).
3. Remove stand(s) and lower vehicle.

### Propeller shaft - rear

#### 47.15.03

##### Remove

1. Raise rear of vehicle.  
**WARNING: Do not work on or under a vehicle supported only by a jack. Always support the vehicle on safety stands.**

2. If same components are to be refitted, reference mark propeller shaft and mating components.

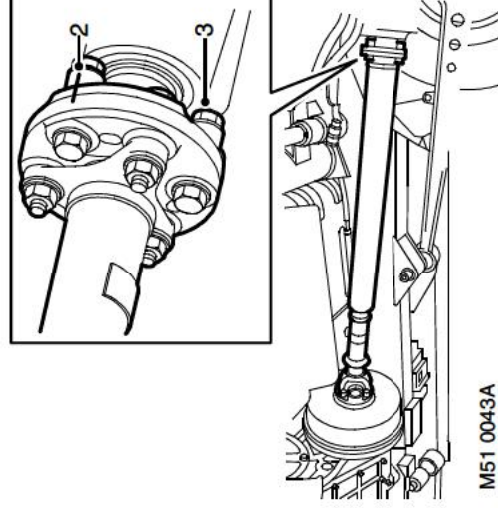

3. Remove 4 nuts and bolts securing propeller shaft to transfer gearbox flange.
4. Remove 3 nuts and bolts securing propeller shaft to flexible coupling.
5. Remove propeller shaft.

##### Refit

1. Clean propeller shaft flanges and mating faces.
2. Position propeller shaft to transfer gearbox and flexible coupling.
3. Fit nuts and bolts securing propeller shaft to transfer gearbox and tighten to 47 Nm (35 lbf.ft).
4. Fit nuts and bolts securing propeller shaft to flexible coupling and tighten to 76 Nm (56 lbf.ft).
5. Lower vehicle.