

Child Restraints

CHILD RESTRAINTS FOR SMALL CHILDREN AND BABIES

Infants and children too small for adult seat belts should be restrained in a child safety seat or restraint system appropriate to their age and/or size.

Child seats and restraint systems designed for your vehicle will be one of two types:

- Those secured in vehicle seats by the seat belts
- 'LATCH' type child restraints employing anchor bars built into the rear seat frame.

All new and most older type child restraint systems incorporate a tether strap which can be attached to an anchorage point on the vehicle. Information about tether strap attachment points and the seat belt locking mechanism, which is used to restrain child seats and restraints, is shown later in this section.

CAUTION: When fitting child seats and restraint systems, always ensure that the manufacturer's fitting instructions are followed exactly. Note that crash statistics show that children are safer when properly restrained in the rear (2nd row) seating positions than in the front.

CHILD RESTRAINTS FOR LARGER CHILDREN

In a situation where a child is too large to fit into a child safety seat, but is still too small to safely fit the 3 point seat belt properly, a booster seat is recommended for maximum safety. Follow the manufacturer's fitting instructions exactly, then adjust the seat belt to suit.

WARNING

- ***DO NOT allow a baby or infant to be carried on the lap. The force of a crash can increase effective body weight by as much as 30 times, making it impossible to hold on to the child.***
 - ***Children typically require the use of a booster seat appropriate to their age and size, thereby enabling the seat belts to be properly fitted, reducing the risk of injury in a crash.***
 - ***Children could be endangered in a crash if their child restraints are not properly secured in the vehicle.***
 - ***DO NOT use a child seat that hooks over the seat back. This type of seat cannot be satisfactorily secured, and is unlikely to be safe for your child.***
 - ***Never leave a child unattended in your vehicle.***
-

Child Restraints

Vehicles fitted with a passenger airbag

Children under 12 years should travel in the rear of the vehicle at all times. Crash statistics show that children are safer when properly restrained in the rear (2nd row) seating positions than in the front.

However, if it is essential that a child travel in the front, set the seat fully rearward and seat the child in a FORWARD FACING child seat.



The above symbol affixed to the passenger side fascia panel of your vehicle, warns against the use of a REAR FACING child seat in the front passenger seat, when a passenger airbag is fitted.

WARNING

EXTREME HAZARD! Do not use a rearward facing child restraint on a seat protected by an airbag in front of it. There is a risk of serious injury or death when the airbag deploys.

Seat belt locking mechanism

All passenger seat belts have a special locking mechanism which aids the securing of child restraints. The mechanism is used to secure a child restraint as follows:

1. Attach the seat belt to the child restraint in accordance with the manufacturer's instructions.
2. Insert the metal tongue of the seat belt into the lock ensuring that it engages with a 'click'.
3. Pull on the shoulder section of the belt until it is fully extended.
4. Allow the belt to retract. A 'clicking' sound will confirm that the mechanism has engaged.
5. Remove all slack from the mechanism, by pulling upwards on the shoulder belt, immediately above the child restraint.
6. Evaluate the tightness of the installation by rocking the child seat back and forth to ensure it is tight and stable.
7. If the child seat needs to be tightened further, remove the metal tongue of the seat belt from the buckle and feed some of the shoulder belt webbing back into the reel (thereby shortening the belt). Then reattach the metal tongue into the buckle (if the belt has been tightened correctly, this will take some effort).
8. Re-evaluate the tightness of the installation. If the child seat is still too loose, repeat the above procedure, making the belt incrementally shorter (and therefore tighter). It may be necessary to put your weight onto the seat (to compress the seat cushion) in order to fasten the belt.

To deactivate the locking mechanism, unlatch the seat belt and allow it to fully retract.

Child Restraints

'LATCH' TYPE CHILD RESTRAINTS

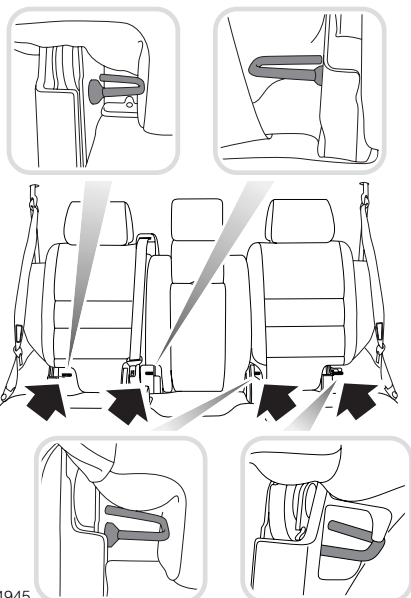
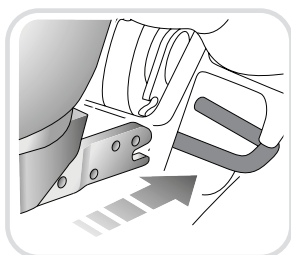

H4945

'LATCH' (Lower Anchors and Tether for Children)

The 'LATCH' three-point type child restraint system complies with Federal Motor Vehicle Safety Standards and is approved for fitting in your vehicle.

Fitting the restraints

This type of child restraint system should only be fitted in the two outer seating positions of the second row seats. Anchor bars built into the rear seat frame enable 'LATCH' type restraints to be securely attached to the vehicle seat in these positions only. The anchor bar locations are shown in the illustration above.

Pass the tether strap over the top of the seat back and beneath the underside of the head restraint. Attach the clip on the head of the tether strap to the appropriate tether anchor and tighten the tether strap.

WARNING

If the restraint is not correctly anchored, there is a significant risk of injury to the child, in the event of a collision or emergency braking.

DO NOT attempt to fit 'LATCH' type restraints to the center seating position - the anchor bars are designed to hold restraints in the outer seating positions only.

When fitting this type of child restraint, always follow the instructions supplied by the manufacturer of the restraint.

Once the restraint is installed, test the security of the installation before seating the child. Attempt to twist the restraint from side to side, and to pull the restraint away from the vehicle seat, then check that the anchors are still securely in place.

Child Restraints

TETHER STRAP ANCHORAGES

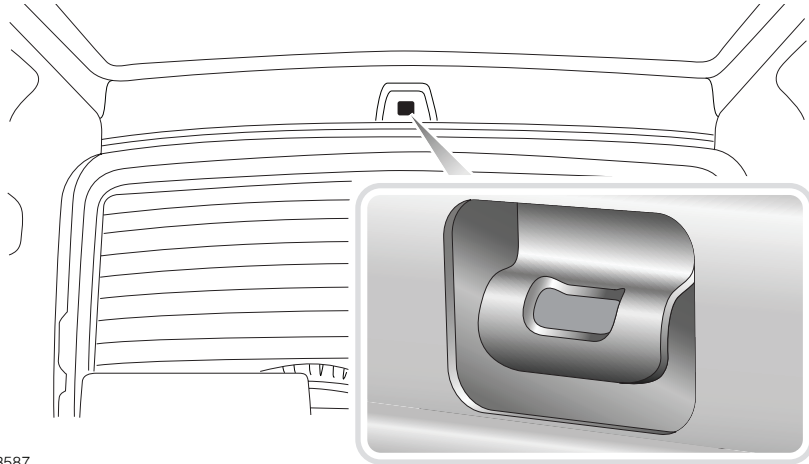

H3587



H3586

Provision is made for the fitting of up to three child seats or restraint systems in the rear (second row) seats, of the type that require tether strap anchorage points.

There are three tether strap anchorage points. These should be used to attach tether straps from child seats or restraint systems. Two anchorage points are fitted to the back of the second row seat, these should be used for the two outer seating positions. A third single anchorage point is located in the center of the rear header rail (above the tail door) for attaching a tether strap from the center seat position. The anchorage points are shown in the accompanying illustrations.

WARNING

Child restraint anchorages are designed to withstand only those loads imposed by correctly fitted child restraints. Under no circumstances should they be used for adult rear seat belts or for harnesses for attaching other items or equipment to the vehicle.

Child Restraints

Attaching tether straps

1. Install the child restraint securely in one of the second row seating positions.
2. Pass the tether strap over the back of the vehicle seat and beneath the underside of the head restraint.
3. Attach the clip on the head of the tether strap to the tether anchor on the back of the vehicle seat (or, for the center seating position, on the header rail above the taildoor).
4. Tighten the tether strap according to the manufacturer's instructions to remove any slack in the webbing.

WARNING

- *Always follow the child seat or restraint system manufacturer's instructions when fitting tether straps.*
 - *When fitting a child seat or restraint system, always pass the tether strap over the top of the seat back and beneath the underside of the head restraint.*
 - *If a child seat or restraint system is to be fitted to the center seating position, the center armrest must be in the stowed position (folded into the seat).*
-