

# ENGINE MANAGEMENT SYSTEM - V8

## Engine management component location - Engine compartment

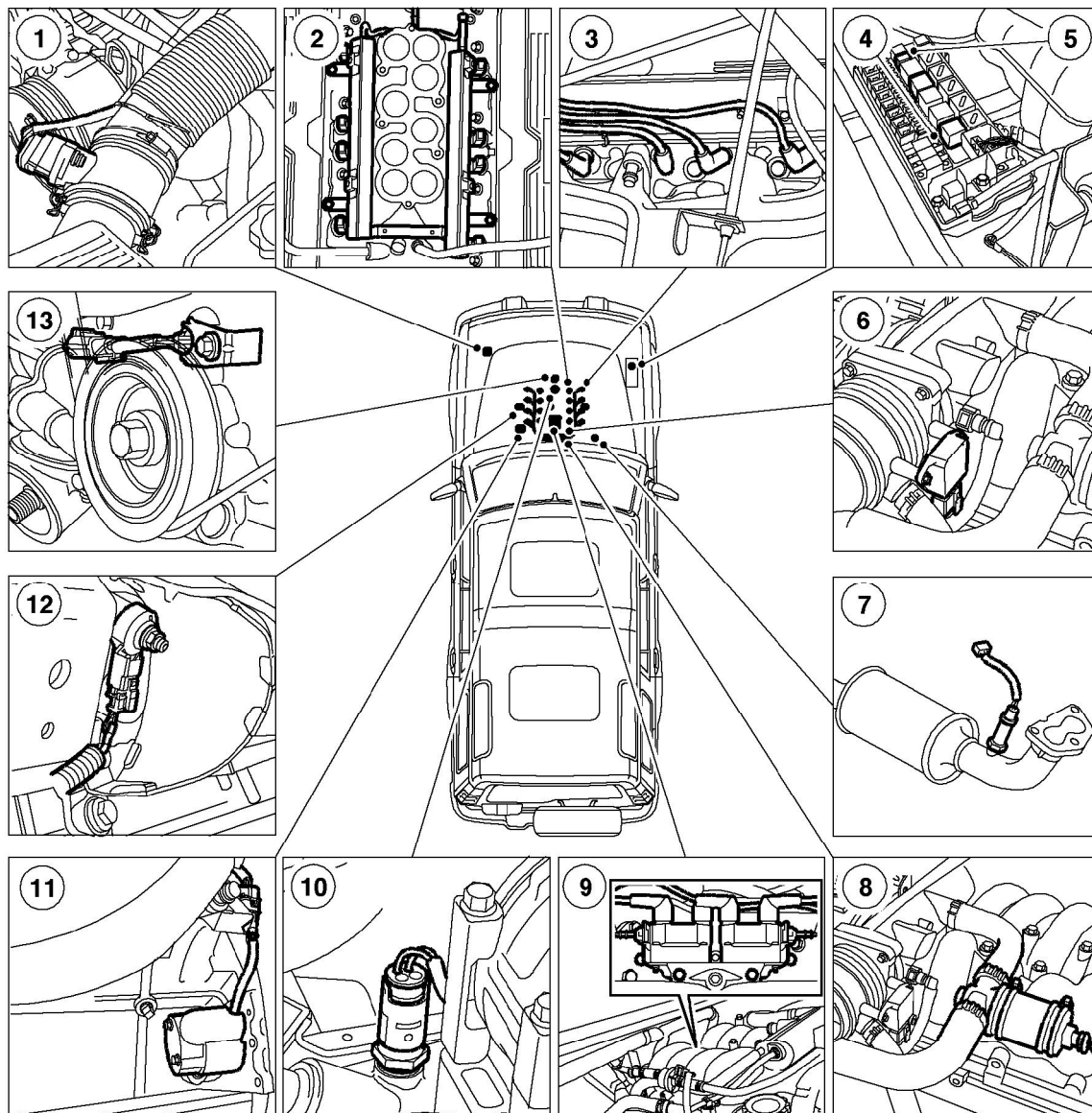

M18 0308



- 1 Mass air flow/ inlet air temperature sensor
- 2 Fuel injectors
- 3 High tension leads/spark plugs
- 4 Fuel pump relay
- 5 ATC compressor clutch relay/ cooling fan relay
- 6 Throttle position sensor
- 7 Heated oxygen sensor
- 8 Idle air control valve
- 9 Ignition coils
- 10 Engine coolant temperature sensor
- 11 Crankshaft speed and position sensor
- 12 Knock sensor
- 13 Camshaft position sensor