

Seal - rear extension housing

➔ 44.20.18

Remove

1. Remove transfer box
👉 **TRANSFER BOX - LT230SE, REPAIRS, Transfer box - Diesel.**
👉 **TRANSFER BOX - LT230SE, REPAIRS, Transfer box - V8.**
2. Drain automatic gearbox oil.
👉 **MAINTENANCE, PROCEDURES, Automatic gearbox.**

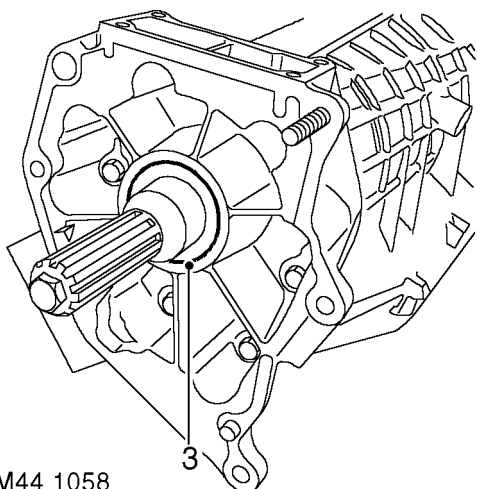

3. Remove rear extension housing oil seal from gearbox.

Refit

1. Clean oil seal recess in gearbox and running surface on input shaft.
2. Lubricate oil seal running surface with transmission oil.

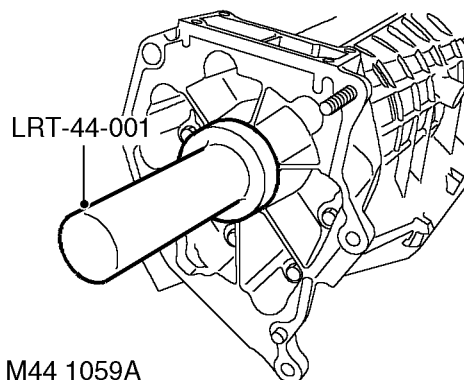



3. Using tool **LRT-44-001** fit oil seal to extension housing.
4. Fit transfer box
👉 **TRANSFER BOX - LT230SE, REPAIRS, Transfer box - Diesel.**
👉 **TRANSFER BOX - LT230SE, REPAIRS, Transfer box - V8.**
5. Fill automatic gearbox with oil.
👉 **MAINTENANCE, PROCEDURES, Automatic gearbox.**



Gasket - rear extension housing.

➔ 44.20.19

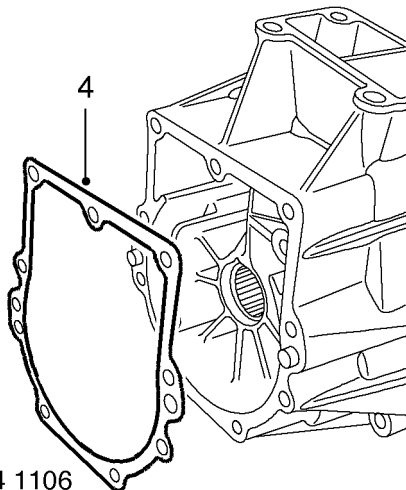
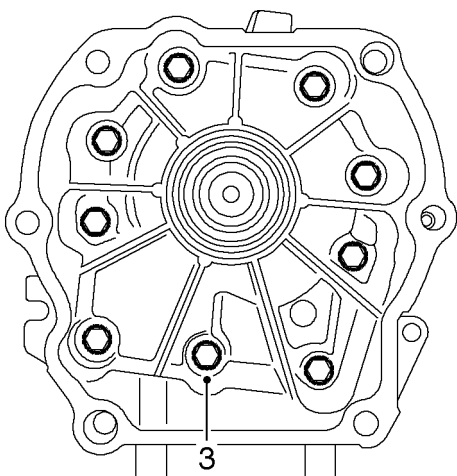

Remove

1. Drain automatic gearbox oil.
 **MAINTENANCE, PROCEDURES, Automatic gearbox.**
2. Remove transfer gearbox.
 **TRANSFER BOX - LT230SE, REPAIRS, Transfer box - Diesel.**
 **TRANSFER BOX - LT230SE, REPAIRS, Transfer box - V8.**



3. Remove 9 bolts securing rear extension housing to gearbox case and remove housing.
4. Remove and discard gasket.

Reassembly

1. Clean rear extension and mating face.
2. Position new gasket to gearbox case.
3. Position rear extension housing and tighten bolts to 25 Nm (18 lbf.ft).
4. Fit transfer gearbox.
 **TRANSFER BOX - LT230SE, REPAIRS, Transfer box - Diesel.**
 **TRANSFER BOX - LT230SE, REPAIRS, Transfer box - V8.**
5. Fill automatic gearbox with oil.
 **MAINTENANCE, PROCEDURES, Automatic gearbox.**