

LIFTING AND TOWING

Raising the front of a vehicle

Position the cup of the hydraulic arm under the centre of the front body crossmember assembly.

Use jack to raise front road wheels to enable safety stands to be installed under the front end of each longitudinal member.

Carefully lower jack until vehicle sits securely on safety stands.

Before working on the underside of a vehicle re-check the stability of the vehicle on the stands.

Use the reverse procedure when removing a vehicle from stands.

NOTE: For some repair operations it may be necessary to use a jack to support the engine under the sump. In this case, a block of wood should be used on the jack to protect the sump.

Raising the rear of a vehicle

Position cup of hydraulic arm under the centre of the rear subframe crossmember at the position identified by the embossed arrows.

Use jack to raise rear road wheels to enable safety stands to be installed under the rear ends of the body longitudinal members.

Carefully lower jack until vehicle sits securely on safety stands.

Before working on the underside of a vehicle, re-check the stability of the vehicle on the stands.

Use the reverse procedure when removing a vehicle from stands.

Wheel-free lift

Locate the lifting pads under the ends of the body longitudinal members. Raise the ramp to support the weight of the vehicle, ensure the vehicle is secure on the lifting pads, then raise the ramp to the required height.

Towing

General

The vehicle has permanent four wheel drive. The following instructions must be adhered to:

Towing the vehicle on all four wheels with driver operating steering and brakes

- Turn ignition key to position '1' to release steering lock and then to position 'II' to enable the brake lights, wipers and direction indicators to be operated, if necessary.
- Select neutral in gearbox and ensure HDC (hill descent control) is deselected.
- Secure tow rope, chain or cable to towing eye.
- Release the parking brake.

CAUTION: The brake servo and power assisted steering system will not be functional without the engine running. Greater pedal pressure will be required to apply the brakes and the steering system will require greater effort to turn the front road wheels. The vehicle tow connection should only be used under normal road conditions, 'snatch' recovery should be avoided.

Suspended tow by breakdown vehicle

Mark propeller shaft drive flanges and mating flanges with identification lines to enable the propeller shaft to be refitted in its original position.

Remove the propeller shaft fixings then remove the shaft from the vehicle.

CAUTION: To prevent vehicle damage, rear propeller shaft MUST BE removed.



If the front of the vehicle is to be trailed, turn ignition key to position 'I' to release steering lock.

WARNING: Do not turn the starter switch to position '0' or remove the ignition key while the vehicle is being towed.

CAUTION: If it is considered unsafe to turn the starter switch to position '1' due to accident damage or an electrical fault; disconnect the battery before turning the ignition switch.

CAUTION: The steering wheel and/or linkage must be secured in a straight ahead position. DO NOT use the steering lock mechanism for this purpose.

CAUTION: Under no circumstances should the vehicle be towed or recovered by means of lashing to the rear subframe. Serious damage to the subframe and body could result.

CAUTION: Only use the rear towing eye for towing another vehicle.

Towing eyes

The towing eyes at the front and rear of the vehicle are designed for vehicle recovery purposes only and must not be used to tow a trailer or caravan.

Transporting the vehicle by trailer

Lashing rings are provided at the front and rear of the body to facilitate the securing of the vehicle to a trailer or other means of transportation.

CAUTION: Underbody components must not be used as lashing points. The lashing rings must not be used for towing.

Install the vehicle on trailer and apply the parking brake. Select neutral.

Lashing eyes

Lashing rings are provided at the front and rear of the vehicle for use when transporting by trailer. DO NOT use lashing eyes for towing purposes.

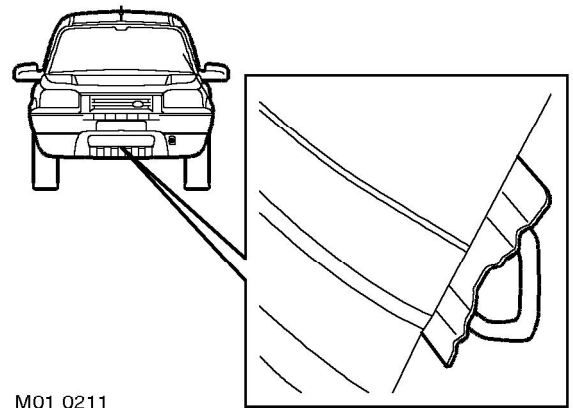

M01 0211

Front lashing eye

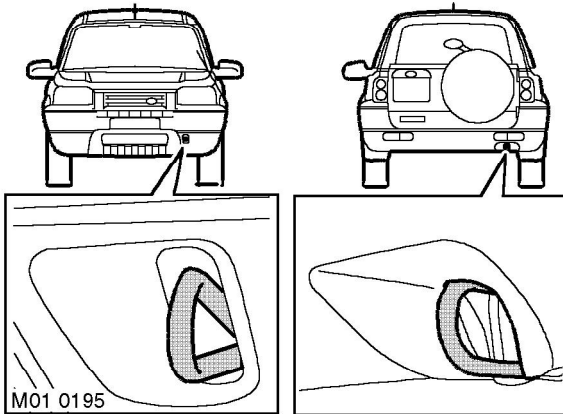

M01 0195

Front and rear towing eyes

A single towing eye is provided in the front spoiler. Only use when the vehicle is to be towed with all four wheels on the ground.

A single towing eye is provided in the rear RH spoiler. Only use when towing another vehicle.

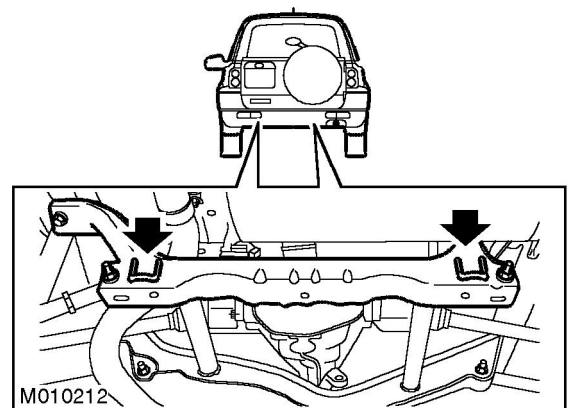

M010212

Rear lashing eyes