

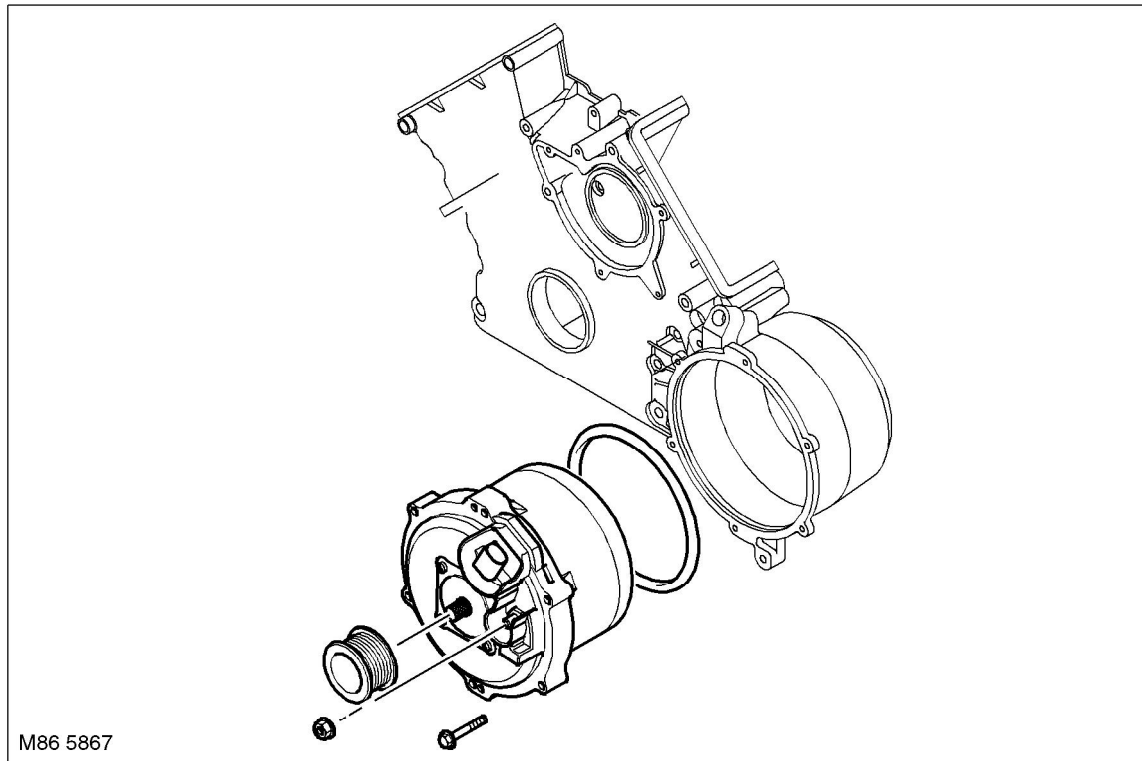

### V8 Alternator



The alternator is located at the front LH side of the engine. The alternator has an output of 90/150 Amps and is manufactured by Bosch. A polyvee belt drives the alternator pulley, which in turn is driven from the engine crankshaft pulley.

### Starter Motor

The starter motors used on the Td6 and V8 engine are different in their construction, but their principles of operation are similar.

Both starter motors are of conventional design with the motor in line with the drive pinion and the solenoid mounted above. Each starter motor is of the pre-engaged type and comprises of a series wound motor, an overrunning clutch and an integral solenoid. The starter solenoid is energised by a signal from the immobilisation ECU when the ignition switch is moved to the crank position. When engine cranking is requested, the immobilisation ECU checks that a valid key code has been received before granting the crank request. The power for starter operation is supplied on a substantial single cable connected direct from the battery positive terminal. The cable is connected to the solenoid via a copper threaded stud and secured with a nut.