

## PARKING BRAKE LEVER

## Remove and refit

## Removing

1. Disconnect the battery negative terminal.
2. Chock the road wheels and release the parking brake.
3. Open the glove box lid and remove the four screws securing the glove box liner to the outer surround and lift out the liner.
4. Remove the two electrical leads at the rear of the glove box cigar lighter and release the two heater hoses from their retaining clamps.
5. Carefully pry the window lift switch panel away from the front of the glove box. Maneuver the panel through the opening and into the inside of the glove box.
6. Remove the main gear selector knob and transfer gearbox knob.
7. Carefully pry the centre panel out of the gearbox tunnel mounted console, and disconnect the electrical multi-plug to the inset graphics panel, withdraw the panel off the main gearbox selector.
8. Remove the cotter pin, plain washer and clevis pin securing the parking brake cable to the parking brake lever.
9. Remove the four bolts and plain washers. Two are located immediately behind the parking brake lever accessible from inside the glove box. The remaining two bolts are located forward of the parking brake lever accessible from the floor mounted console opening.

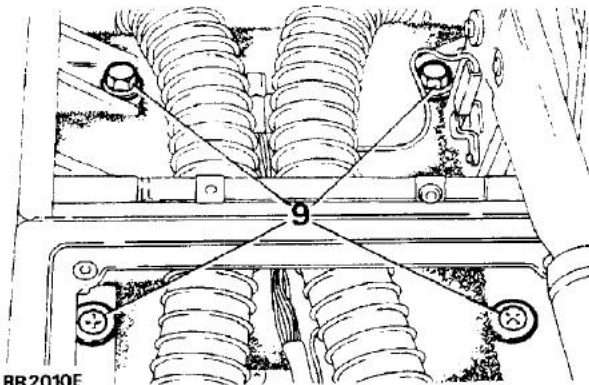

RR2010E

10. Raise the parking brake lever to its uppermost position and ease the glove box and console assembly rearwards to release the location tab from the radio housing, lift the assembly off the gearbox tunnel.
11. Disconnect the electrical lead from the parking brake warning switch.
12. Release the parking brake cable outer retaining nut.
13. Remove the remaining single bolt with plain washer securing the front of the parking brake mounting bracket.
14. Withdraw the parking brake lever assembly off the parking brake outer cable.

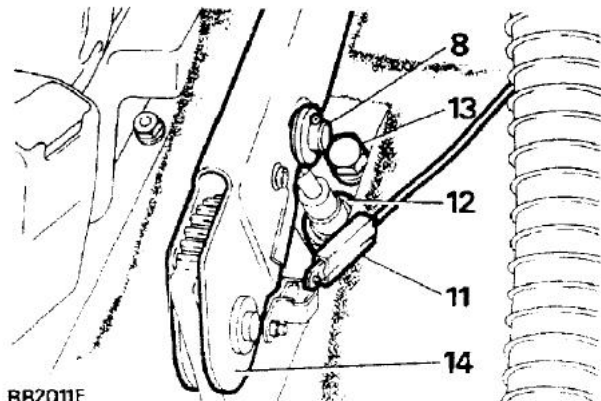

RR2011E

## Refitting

15. Fit the parking brake lever to the gearbox tunnel and secure in position with the single bolt (with plain washer) forward of the lever mounting bracket.
16. Secure the outer parking brake cable to the mounting plate and tighten the nut securely.
17. Refit the glove box/console assembly and secure in position, tightening the remaining bolt and two screws securely.
18. Fit the inner parking brake cable to the parking brake lever using a **new** cotter pin.
19. Reverse the remaining removal instructions, ensuring that the electrical wiring in the glove box assembly is arranged to prevent it from becoming trapped between any mating faces.

**OVERHAUL PARKING BRAKE**

**WARNING:** Do not use an air line to remove dust from the brake assembly. Asbestos dust from the brake linings can be a serious health risk, if inhaled.

**DISMANTLING**

1. Disconnect the battery negative terminal and chock the road wheels for safety. Release the parking brake, select 'P' in main gearbox and release the parking brake.
2. Disconnect the drive shaft from the output flange.
3. Loosen off the brake adjuster, remove the two screws and withdraw the brake drum. Inspect the friction surface of the drum, turn if excessively scored or oval.

**NOTE:** If drum requires skimming the maximum diameter is 255.65 mm (10.06 in).

4. Remove the cotter pin and clevis pin connecting the parking brake inner cable to the brake actuating lever.
5. Remove the brake shoes complete with pull-off springs. Note position of springs in relation to the shoes.
6. Remove the four bolts securing back plate to transfer box and withdraw the back plate complete with oil catcher.

**Remove and overhaul expander assembly**

7. Remove the rubber dust cover.
8. Remove the expander and drawlink.
9. Remove the retainer spring plate.
10. Remove the locking plate.
11. Remove the packing plate and withdraw the expander assembly from the back plate.
12. Remove the two plungers and rollers.

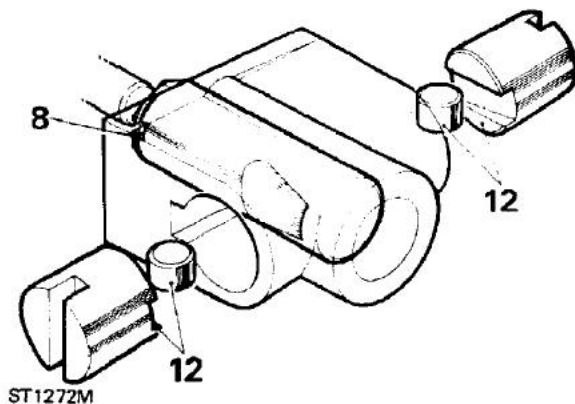

13. Clean all parts in aerosol brake cleaner and allow to dry. Examine the components for wear and discard if unsatisfactory.

**Assemble expander assembly**

14. Grease and fit the expander and drawlink.
15. Grease and fit the plungers and rollers, fitting the plungers with the highest end of the roller groove towards the backplate.

**Remove and overhaul adjuster assembly**

16. Remove the two bolts and withdraw the adjuster assembly from the back plate.
17. Remove the plungers.
18. Screw the adjuster cone inwards to remove from the housing.

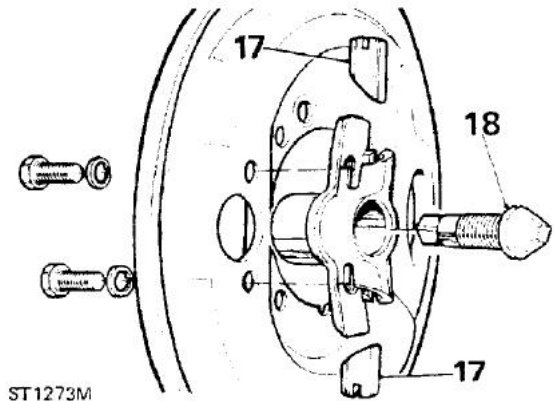

19. Thoroughly clean the parts in aerosol brake cleaner and discard any unsatisfactory components.

**KEY TO PARKING BRAKE**

- |                                 |                                   |
|---------------------------------|-----------------------------------|
| 1. Brake drum                   | 8. Oil catcher                    |
| 2. Brake drum retaining screws  | 9. Back plate and retaining bolts |
| 3. Brake shoes                  | 10. Dust cover                    |
| 4. Brake shoes pull-off springs | 11. Locking plate                 |
| 5. Expander assembly            | 12. Packing plate                 |
| 6. Adjuster assembly            | 13. Spring plate                  |
| 7. Drawlink                     |                                   |

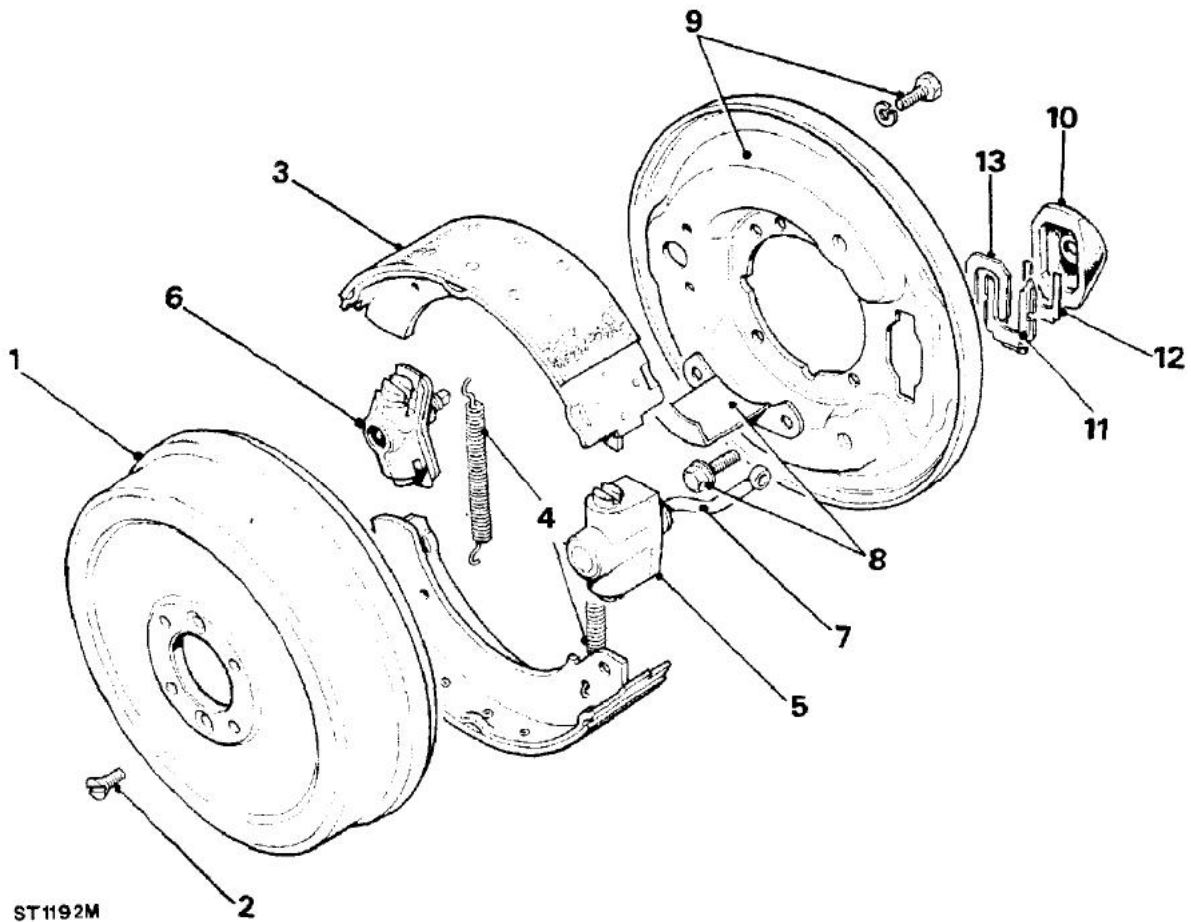

**Assembly adjuster assembly**

20. Grease and screw in the adjuster cone.
21. Grease and fit the adjuster plungers and align the chamfered ends with the adjuster cone. Note that the two plungers are identical and can be fitted to either bore. Secure the assembly with a rubber band to prevent the plungers falling out.

**ASSEMBLE**

**NOTE: If the brake linings are oil-soaked, fit new brake shoes. Check and if necessary fit a new output shaft oil seal.**

22. Position the expander assembly on the inside of the back plate and secure with the following plates at the rear of the back plate.
23. Spring plate.
24. Locking plate.
25. Packing plate.
26. Fit the rubber dust cover.

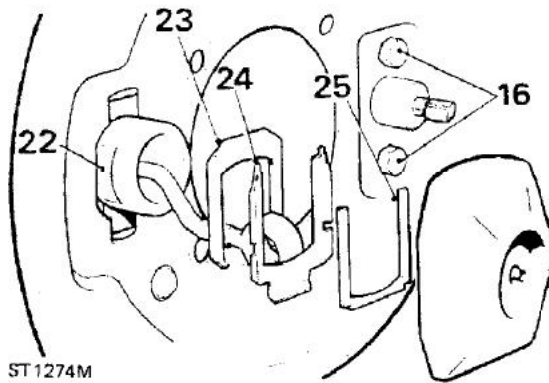

27. Fit the adjuster assembly to the back plate with the two bolts but do not fully tighten at this stage.
28. Fit the back plate assembly and oil catcher to the transfer box with the four bolts and tighten to the correct torque (see section 06-Torque values).

29. Fit new pull-off springs to the brake shoes and fit to the back plate.

**NOTE: That the fully lined end of the lower shoe must be toward the expander assembly and the fully lined end of the upper shoe towards the adjuster assembly.**

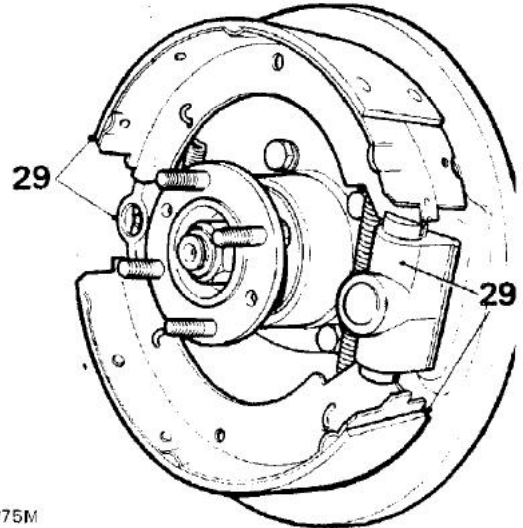

ST 1275M

30. Fit the brake drum and tighten the two screws to the correct torque (See Section 06 Torque Values)
31. Connect the actuating lever to the inner parking brake cable using a new clevis pin, washer and cotter pin.
32. Turn the adjuster cone fully in and tighten the two retaining bolts left loose in instruction 27.
33. Loosen the adjuster two 'clicks' and firmly apply and release the parking brake lever to centralise the shoes. The drum should then rotate freely.
34. Adjust the parking brake cable lock nuts until the parking brake lever is fully operational on the second or third notch of the parking brake ratchet.
35. Connect the drive shaft and evenly tighten the retaining nuts to the correct torque (see section 06-Torque values).
36. Remove chocks from wheels and connect the battery.

## PARKING BRAKE CABLE

## Remove and refit

## Removing

1. Set the vehicle on a level surface and chock the road wheels and select 'P' in the main gearbox.
2. Disconnect the battery negative terminal and release the parking brake.

## From inside the vehicle

3. Remove the four screws securing the liner in the glove box.
4. Lift out the liner to gain access to the bottom of the parking brake pivot bracket.
5. Remove the cotter pin and clevis pin from the parking brake lever.
6. Release the nut securing the parking brake outer cable to the top of the parking brake mounting bracket. Slide the nut up the cable and push the inner and outer cable through the floor panel to the underside of the vehicle.

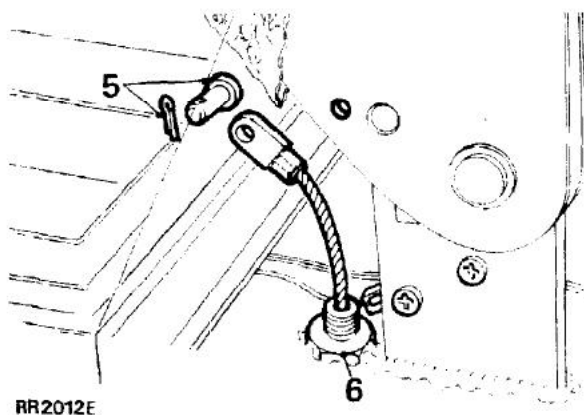

RR2012E

## From underneath the vehicle

7. Remove the cotter pin, plain washer and clevis pin securing the adjustment link to the brake drum actuating lever.

8. Release the locknuts securing the parking brake outer cable to the retaining bracket.
9. Release the outer cable from the 'P' clamp located on top of the transfer gearbox, and withdraw the cable assembly from the vehicle.

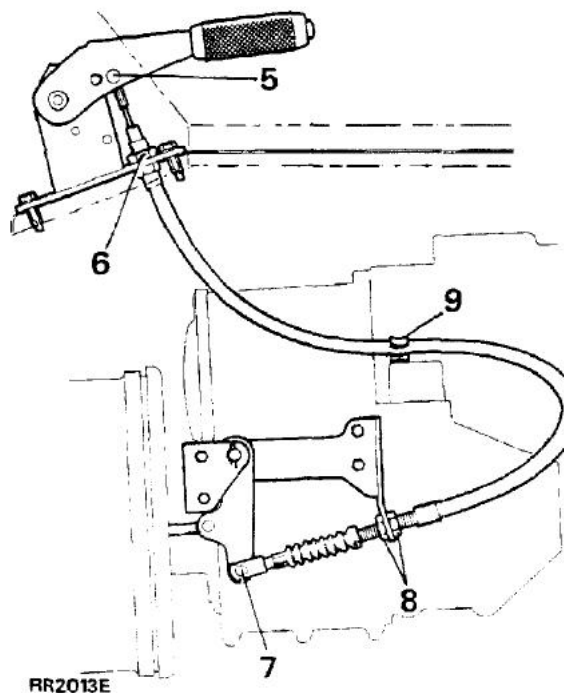

RR2013E

## Fit new cable

10. Feed the parking brake cable assembly through the floor opening and secure the outer cable in position with the retaining nut.
11. Secure the cable to the parking brake lever, using a **new** cotter pin.
12. Secure the outer cable into the 'P' clamp.
13. Position the outer cable into the retaining bracket bolted to the side of the transfer gearbox and loosely secure in position with the two outer cable lock nuts.
14. Reconnect the outer cable to the brake drum actuating lever. Fit the clevis pin, plain washer and **new** cotter pin.
15. Rotate the brake drum adjuster clockwise until the brake shoes are fully expanded against the drum.
16. Tighten the two brake cable outer lock nuts to secure the cable to its mounting bracket.
17. Apply the parking brake, and loosen the brake drum adjuster until the parking brake lever fully operates the brake shoes on the second or third notch of the parking brake ratchet.
18. Refit the glove box liner.