



**Jacking**

The following instructions must be carried out before raising the vehicle off the ground:

- Use a solid level surface.
- Apply parking brake.
- Select 1st. gear in main gearbox and ensure HDC is not selected.

**CAUTION: To avoid damage to under body components of the vehicle, adhere to the following jacking procedures:**

**DO NOT POSITION JACKS OR AXLE STANDS UNDER THE FOLLOWING COMPONENTS:**

- Bumpers
- Brake or Fuel lines
- Exhaust pipe
- Suspension components
- Steering rack and linkages
- Fuel tank
- Engine sump
- Gearbox
- IRD unit

**Jack or support vehicle only on approved jacking points as detailed in the following illustration:**

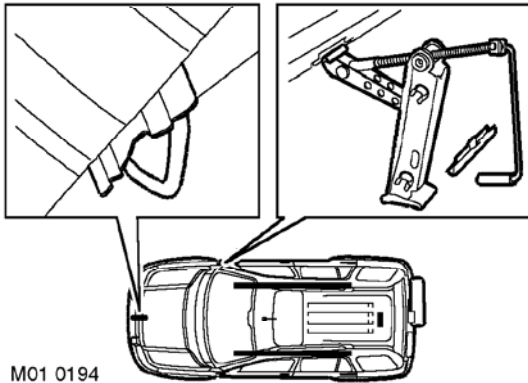

*Front (hydraulic jack) and side (vehicle jack) jacking points*

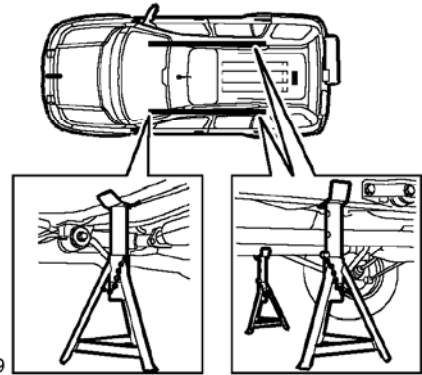

*Safety stand positions under longitudinal members*

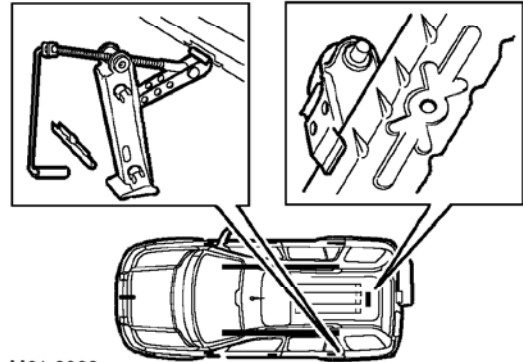

*Rear (hydraulic jack) and side (vehicle jack) jacking points*

**Vehicle jack**

The jack provided with the vehicle is only intended to be used in an emergency, for changing a tyre. Do **NOT** use the jack for any other purpose. Refer to the Owner's Handbook for vehicle jack location points and procedure. Never work under a vehicle only supported by the vehicle jack.

**Hydraulic jack**

A hydraulic jack with a minimum 1500 kg (3,300 lbs) load capacity must be used.

**WARNING: Do not work on or under a vehicle supported only by a jack. Always support the vehicle on safety stands.**