

ENGINE - V8

Lubrication

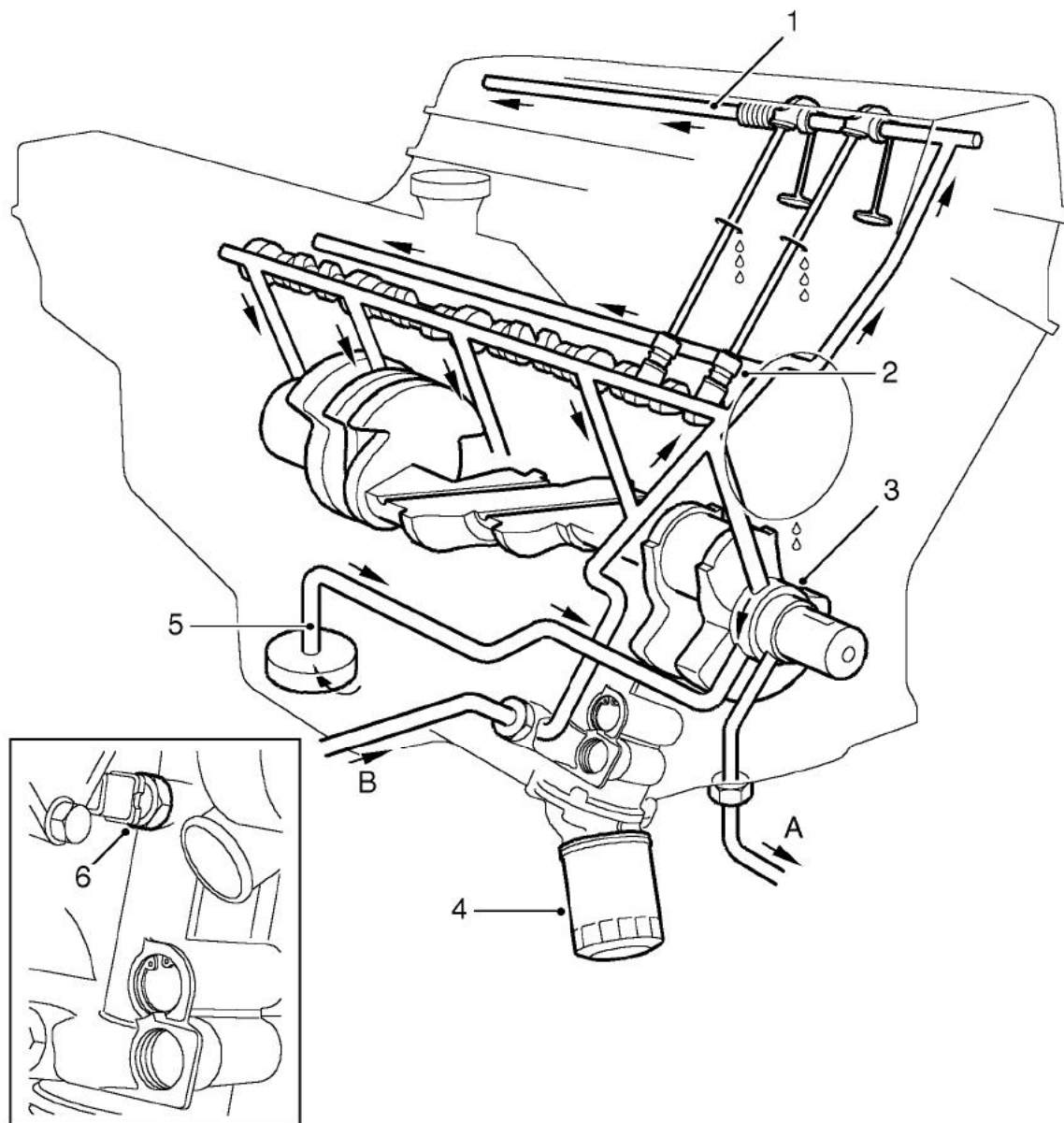

M12 4700A

A - To oil cooler, B - From oil cooler

NOTE: The oil cooler is only fitted to vehicles up to VIN 756821.

- 1 Rocker shaft assembly
- 2 Hydraulic tappet
- 3 Oil pump

- 4 Oil filter element
- 5 Oil pick-up pipe and strainer
- 6 Oil pressure switch



Oil is drawn from the sump through a strainer and into the oil pump via the oil pick-up pipe. Pressurised oil from the pump passes through the oil cooler (if fitted) mounted in front of the radiator and returns to the full flow oil filter element. Oil from the filter passes into the main oil gallery and through internal drillings to the crankshaft where it is directed to each main bearing and to the big-end bearings via numbers 1, 3 and 5 main bearings. An internal drilling in the cylinder block directs oil to the camshaft where it passes through further internal drillings to the hydraulic tappets, camshaft bearing journals and rocker shafts. Lubrication to the pistons, small ends and cylinder bores is by oil grooves machined in the connecting rods and by splash.

Oil pressure switch

The oil pressure warning light switch registers low oil pressure in the main oil gallery on the outflow side of the filter. Whilst the engine is running and oil pressure is correct, the switch is open. When the ignition is switched on or if oil pressure drops below the pressure setting of the switch, the switch closes and the low oil pressure warning lamp located in the instrument pack will illuminate.

Hydraulic tappets

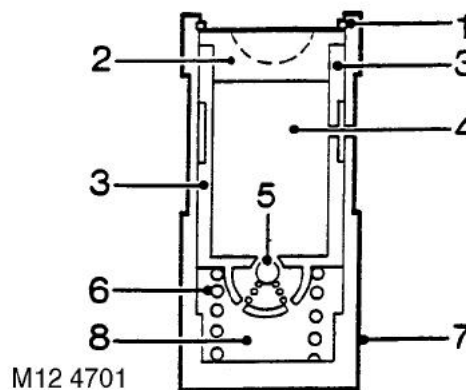

- | | |
|-----------------|-------------------------|
| 1 Clip | 5 Non-return ball valve |
| 2 Pushrod seat | 6 Spring |
| 3 Inner sleeve | 7 Outer sleeve |
| 4 Upper chamber | 8 Lower chamber |

The hydraulic tappet provides maintenance free, quiet operation of the valves. This is achieved by utilizing engine oil pressure to eliminate the clearance between the rocker arms and valve stems. When the valve is closed, engine oil pressure present in the upper chamber, passes through the non-return ball valve and into the lower chamber. When the cam begins to lift the outer sleeve, the resistance of the valve spring, felt through the push rod and seat, causes the tappet inner sleeve to move downwards inside the outer sleeve. This downwards movement closes the non-return ball valve and increases the pressure in the lower chamber sufficiently to ensure that the valve is fully opened by the push rod. As the tappet moves off the peak of the cam, the non-return ball valve opens thereby allowing the pressure in both chambers to equalize. This ensures that the valve will be fully closed when the tappet is on the back of the cam.

Crankcase ventilation

A positive crankcase ventilation system is used to vent crankcase gases to the air induction system. Gases are drawn from the left hand rocker cover to a tapping in the throttle body. An oil separator is incorporated in the hose connection stub pipe in the right hand rocker cover, gases from this connection are drawn to a tapping in the inlet manifold.

EMISSION CONTROL - V8, DESCRIPTION AND OPERATION, Crankcase Emission Control System.



Engine oil pressure check

➔ 12.90.09.01

Check

1. Remove oil pressure switch.
 ➔ **ENGINE - V8, REPAIRS, Switch - oil pressure.**

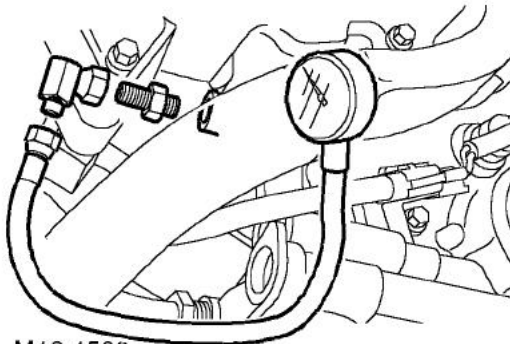

M12 4589

2. Connect pressure check kit **LRT-12-052C** adaptor and gauge to oil pressure switch position on timing gear cover.
3. Check and if necessary top up engine oil.
4. Run engine at idle speed and check that oil pressure is within limits given.
 ➔ **GENERAL DATA, Engine - V8.**
5. Switch off ignition.
6. Remove pressure check kit **LRT-12-052C**.
7. Clean oil spillage.
8. Fit oil pressure switch.
 ➔ **ENGINE - V8, REPAIRS, Switch - oil pressure.**

Adjust

1. If engine oil pressure is below figures given, check condition of oil pump and/or main and big end bearings.