

## Information displays

### PERSONALISED SETTINGS

Various trip computer settings can be selected, by the driver, to suit personal requirements. All of the selections made are associated with the remote control that was used during the process. These choices are recalled when the vehicle is next unlocked using that remote control. See **MEMORY FUNCTION** (page 131).

With the starter key in any position, the vehicle stationary and a blank display, a short press (less than two seconds) on the **i** button brings up the **SETTINGS** display.

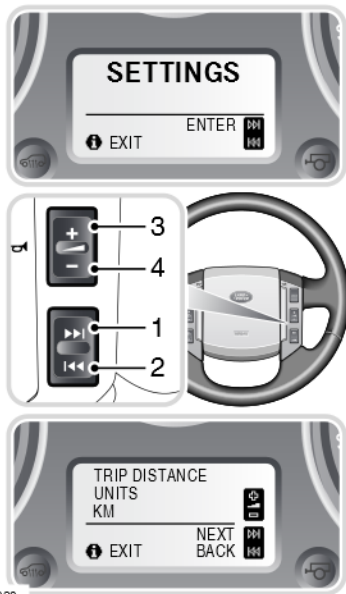

E81030

Press button **1** to access the settings that can be personalised.

Move through the menu, by pressing buttons **1** or **2**, and make selections by pressing buttons **3** or **4**.

When selections are complete, a short press (less than two seconds) on the **i** button will save the settings and return to the trip computer display.

**Note:** *If the vehicle is moved while changes are being made, the system will prevent any further input until the vehicle is stationary again.*

TRIP COMPUTER SETTINGS	SELECTION
TRIP DISTANCE UNITS (odometer)	MILES/KM
FUEL USAGE UNITS	MPG l/100km Km/l
EXTERNAL TEMPERATURE	°C or °F
OVERSPEED WARNING	Off 20 - 250 km/h or 15 to 140 mph in 5-unit steps
HEADLAMP OFF DELAY	30/60/120/240 seconds
AUTO DOOR LOCK (speed related locking)	ON/OFF
REVERSE MIRROR DIP	ON/OFF
LAZY ENTRY	ON/OFF
RESTORE DEFAULT SETTINGS	YES/NO